

# RAINFALL AT Rohenden

R. Appach Esq. Kent

60

Rain { By .....  
 Gauge { ..... R. & Z. .....  
 Diameter.....R......in. Height above Ground, ... ft. 2... in. Above Mean Sea Level, ..... ft.

1 - Rother.

YEAR .....	1860	1861	1862	1863	1864	1865	1866	1867	1868	1869	MEANS.
January .....						4.75	5.14	4.17	4.53	2.86	
February .....						3.02	4.43	1.95	1.03	3.00	
March .....						1.71	2.23	3.19	2.08	2.35	
April .....					* .51	.18	2.01	1.47	2.12	1.39	
May .....					2.36	3.42	.65	3.28	1.16	4.30	
June .....					1.55	1.05	2.87	1.61	.31	1.03	
July .....					.55	4.30	1.65	5.18	2.09	.19	
August .....					1.61	3.62	3.35	1.34	3.43	1.52	
September ...					3.49	.10	5.08	1.51	1.54	3.34	
October .....					1.79	9.39	1.33	2.61	3.28	3.08	
November ...					6.50	3.55	1.97	1.33	2.04	2.23	
December .....					.94	1.11	2.02	2.60	7.57	3.43	
TOTALS .....						36.20	32.73	30.24	31.18	28.72	

c c c c c c

1869 Dec. 15<sup>th</sup> gauge blown over in the storm so  
 return for that day doubtful



RAINFALL AT TenterdenObserver J. Ellis Maudslayi

Rain { By .....

Gauge { Diameter 8 in.Height above Ground 1 ft. 4 in.Above Mean Sea Level 242 ft.1 - Rother.

YEAR.....				1863	1864	1865	1866	1867	1868	1869	MEANS.
January.....					.86	4.50	4.28	4.05	3.79	2.60	
February .....					1.33	2.58	4.06	1.68	1.33	2.90	
March .....					2.51	1.57	2.08	3.13	1.51	2.45	
April.....					.63	.24	2.10	1.59	1.69	1.28	
May .....					2.09	3.24	1.94	2.99	1.28	4.04	
June.....				# 3.04	.95	1.12	1.55	1.50	.34	1.09	
July .....				.60	.35	4.34	2.02	4.87	1.89	.21	
August.....				1.96	1.45	3.45	3.49	1.17	2.91	1.43	
September.....				3.95	3.54	.06	5.56	1.82	2.01	2.86	
October.....					1.58	9.18	1.34	2.65	2.69	2.85	
November.....				} 4.17	6.28	2.72	2.09	1.03	2.05	2.06	
December.....				1.90	.83	1.59	1.93	2.45	7.04	3.42	
TOTALS .....					22.40	34.59	32.44	28.93	28.53	27.19	

g in garden with slight slope towards NW a few small trees about but not any very near.



Rainfall at HytheKentW B MackesonM & Z

Diameter of Gauge, ..... 8 ..... in.

Height above Ground, ..... ft. 6 ..... in.

Above Mean Sea Level, ... 12<sup>p</sup> ..... ft.1- Rother.

YEAR - -	1860	1861	1862	1863	1864	1865	1866	1867	1868	1869	MEANS.
January - -						5.03	4.30	5.64	4.26	2.74	
February - -						2.67	4.29	1.34	1.17	2.49	
March - - -						2.48	3.02	3.56	1.35	4.70	
April - - -						.26	1.09	1.78	2.04	1.83	
May - - - -						3.08	1.13	3.71	2.17	4.57	
June - - - -						1.69	2.25	1.18	.63	1.00	
July - - - -						2.95	2.40	4.36	2.01	.44	
August - - -						3.19	3.77	1.20	3.96	2.10	
September -						.23	5.54	.99	3.38	3.15	
October - -						9.43	.68	2.90	2.84	2.22	
November -						3.26	2.30	1.97	2.34	2.97	
December -						1.49	1.80	2.63	6.35	4.90	
TOTALS -						35.76	32.57	31.26	32.50	33.11	

c c c c c

g in Kitchen garden from trees

Returns doubtful; some of the later years recorded by  
the same observer are undoubtedly wrong.



Rainfall at Sandgate

J. Du Boulay Esq.  
M & L.

Diameter of Gauge, ..... in.

Height above Ground, 1 ft. .... in.

Above Mean Sea Level, 25.7 ft.

1 - Potter

YEAR - -	1860	1861	1862	1863	1864	1865	1866	1867	1868	1869	MEANS.
January - -					.64						
February - -					1.77						
March - - -					2.57						
April - - - -					.48						
May - - - - -					2.28						
June - - - - -					2.11						
July - - - - -					.56						
August - - -					1.49						
September -					3.01						
October - - -					1.32						
November -					5.18						
December -					.74						
TOTALS -					22.15						

C



60

RAINFALL AT Folkestone NW Cherry Gardens.

Observer Hy. Turner.

Rain { By.....  
Gauge { .....  
Diameter.....8.....in. Height above Ground, 3.....ft. 6.....in. Above Mean Sea Level 140.....ft.

1- Potter.

YEAR.....	1860	1861	1862	1863	1864	1865	1866	1867	1868	1869	MEANS.
January.....									<del>#</del> 3.88	2.16	
February.....									.99	2.39	
March.....									1.20	4.16	
April.....									1.93	1.80	
May.....									1.21	3.85	
June.....									1.25	.81	
July.....									1.68	.16	
August.....									3.65	2.04	
September.....									1.60	2.28	
October.....									2.88	2.29	
November.....									1.99	2.34	
December.....									5.57	4.19	
TOTALS.....									27.83	28.47	

Recd. about I. 1896.

Entered X. 1909.







RAINFALL AT *Folkestone Cherry Gardens*  
*Kent*

Observer *H Turner Esq*

Rain { By .....  
Gauge { .....  
Diameter.....*8*.....in.      Height above Ground,.....*3.6*.....ft.....in.      Above Mean Sea Level *140*.....ft.

*1 - Rother*

YEAR.....										<i>1868</i>	<i>1869</i>	MEANS.
January.....										<i># 3.88</i>	<i>2.16</i>	
February .....										<i>.99</i>	<i>2.39</i>	
March .....										<i>1.20</i>	<i>4.16</i>	
April .....										<i>1.93</i>	<i>1.80</i>	
May .....										<i>1.21</i>	<i>3.85</i>	
June .....										<i>1.25</i>	<i>.81</i>	
July.....										<i>1.68</i>	<i>.16</i>	
August.....										<i>3.65</i>	<i>2.04</i>	
September .....										<i>1.60</i>	<i>2.28</i>	
October .....										<i>2.88</i>	<i>2.29</i>	
November .....										<i>1.99</i>	<i>2.34</i>	
December.....										<i>5.57</i>	<i>4.19</i>	
TOTALS.....										<i>27.83</i>	<i>28.47</i>	



# Dover, Castle S<sup>e</sup>

H J Poulter Esq<sup>r</sup>

Mpi Ret No 110  
2.2 65

Diam 5 in + ground 8 in + Sea Level 30 ft <sup>16 65 69</sup>

1 - Rather.

YEAR - -	1860	1861	1862	1863	1864	1865	1866	1867	1868	1869	MEANS.
January - -	3.99	1.05	1.96		.68	5.49	4.88	3.75	4.58	2.80	
February - -	1.82	1.44	.49		1.97	2.61	3.95	1.66	1.37	2.95	
March - - -	2.80	1.91	3.80		2.66	2.27	3.00	2.95	1.45	3.52	
April - - -	1.79	.89	1.64		.61	.24	2.00	1.51	1.97	2.58	
May - - - -	4.03	1.60	2.80		2.18	2.53	1.12	2.57	1.77	3.95	
June - - - -	3.31	3.49	1.37		1.91	1.46	2.66	1.17	.73	.90	
July - - - -	1.90	1.88	2.09		.32	4.35	2.55	3.62	.85	.34	
August - - -	3.75	2.29	1.82		1.69	3.76	4.24	.92	4.32	1.78	
September -	3.69	4.16	1.20		2.44	.15	6.13	1.22	1.67	3.21	
October - - -	2.18	1.57	5.33		1.62	9.23	.84	2.67	3.55	1.93	
November - -	3.25	5.99	.65		5.96	4.58	2.88	2.23	2.41	2.09	
December - -	3.74	1.40	1.78		1.00	1.36	2.70	2.64	6.31	4.45	
TOTALS -	36.25	28.41	<del>24.93</del>		23.04	38.03	36.95	26.91	30.98	30.50	

✓ ✓ ✓ ✓ ✓ ✓ ✓ ✓

Gauge wrong from Feb. 1862 to end of 1863



Dover Castle Keep

H J Poulton

512

+ Sea level 482 ft.

1- Rotten.

g. on N.E. turret

g. on S.W. turret

YEAR - -	1860	1861	1862	1863	1864	1865	1866	1867	1868	1869	MEANS.
January - -				1.73	.37	1.21	.68	.80	1.06		
February - -			.31	.73	.40	.74	.98	.49	.35		
March - - -			2.85	.67	1.57	.69	1.47	1.42	.16		
April - - -			1.17	.72	.52	.10	1.51	.12	.88		
May - - -			1.78	1.49	1.43	1.40	.85	2.08	1.08		
June - - -			.86	1.69	1.10	.80	.97	.45	.24		
July - - -			1.90	.35	.12	1.36	1.00	1.66	.40		
August - -			1.48	.70	1.10	2.38	2.13	.15	2.80		
September -			.93	1.51	.27	.00	1.83	.55	.65		
October - -			2.78	2.50	.69	3.88	.30	.73	1.15		
November -			.34	1.10	2.67	1.46	.57	1.17	1.31		
December -			1.01	.42	.59	.55	.44	.80	1.51		
TOTALS -				13.61	10.83	14.57	12.73	10.42	11.59		

1863 Gone. no indication at 16 ft. at the same time  
 the highest tint at 512 ft., on the 9<sup>th</sup> of May swarms  
 of a species of small black fly preceded wet wea-  
 ther Nov. 2<sup>nd</sup>. Hurricane causing a great inland  
 of the sea

1864 g placed on Turret NE of Castle tried on SW  
 Turret, the quantity was diminished one half



Horton Park

w. Hythe

John Kirkpatrick Esq

1-4 67

350 650

M &amp; Z 8 + ground. 1.00 + Sea Level 280 ft?

2-Store.

YEAR - -	1860	1861	1862	1863	1864	1865	1866	1867	1868	1869	MEANS.
January - -	3.77	.34	2.10	4.23	1.11	4.15	4.30	3.04	3.84	2.79	2.967
February - -	2.15	2.07	.60	1.38	2.27	3.05	4.71	1.50	1.37	2.38	2.148
March - - -	2.70	2.48	4.57	1.07	2.57	3.63	2.73	3.22	1.49	3.50	2.796
April - - -	3.07	.61	2.16	1.34	.46	.36	1.29	1.67	1.92	1.91	1.479 -
May - - - -	4.45	1.93	3.07	1.94	2.15	3.42	1.14	3.49	1.29	3.86	2.674
June - - - -	3.45	3.08	1.84	2.51	2.48	1.03	2.45	1.30	.71	1.25	2.090
July - - - -	3.40	2.22	2.01	.79	.71	3.55	2.84	4.47	1.18	.32	2.149
August - - -	5.26	1.75	2.38	2.75	1.59	3.97	4.46	1.12	4.48	2.79	3.055
September -	8.03	3.59	2.07	3.25	2.96	.54	5.41	1.34	2.52	3.32	3.303
October - -	2.43	1.29	5.73	3.38	1.22	9.79	1.14	2.73	2.83	2.04	3.258
November -	4.52	6.99	.78	2.14	5.29	4.88	2.94	1.99	2.81	2.62	3.496 +
December -	6.19	2.78	3.43	1.99	.92	1.62	2.33	2.51	6.74	4.11	3.262
TOTALS -	49.42	29.93	30.74	26.77	23.73	39.99	35.74	28.38	31.18	30.89	32.677

+ c c c c c - c c c c c c

1860 this total is doubtful as the gauge was twice filled and upset thereby

At the foot of the chalk hills which seem to attract the moisture brought up the channel by the S W winds in a somewhat different manner from Sandgate  
 1863 g is in a hole on a grass plot so as to make it level with the surface



# RAINFALL AT Walton, Easting, Sandwich

60

Col. Jas. A. Rae

Kent

Rain { By.....  
Gauge { Diameter.....1.....in.

Height above Ground, 1..... ft. .... in.

Above Mean Sea Level, ..... ft.

2 - Gours.

YEAR.....							1866	1867	1868	1869	MEANS.
January .....								2.74	1.15	2.08	
February .....								1.34	1.81	2.94	
March .....								2.23	.36	2.93	
April .....							1.99	.92	2.22	1.65	
May .....							1.29	3.40	1.96	2.74	
June.....							2.31	1.15	.74	.78	
July .....							1.85	1.75	.92	.41	
August.....							3.18	1.38	3.69	1.62	
September ...							4.25	.94	1.77	1.45	
October.....							.42	1.78	1.66	3.02	
November.....							1.97	1.28	1.31	1.97	
December.....							1.58	2.06	3.97	2.70	
TOTALS .....								20.97	21.56	24.29	

c c c c



RAINFALL AT CharthamE. J. DrewN. LeanterburyRain { By .....  
Gauge { Diameter ..... in.Height above Ground, 2 ft. 6 in.

Above Mean Sea Level, ..... ft.

L. Stour.

YEAR .....	1860	1861	1862	1863	1864	1865	1866	1867	1868	1869	MEANS.
January .....						3.96	2.96	2.20	3.37	2.08	
February .....						2.27	3.79	1.36	1.37	3.22	
March .....						2.24	2.39	2.75	1.01	2.88	
April .....						.41	2.11	1.14	1.71	1.37	
May .....						2.83	1.19	2.90	1.42	4.20	
June .....						.76	2.14	1.27	.44	.98	
July .....						2.74	2.39	3.16	.86	.29	
August .....						4.53	3.55	.96	2.48	1.23	
September ...						.35	4.64	1.55	3.73	2.47	
October .....						8.68	.75	1.81	1.94	3.14	
November ...						4.27	2.12	1.39	2.19	2.31	
December .....						1.34	1.39	1.45	5.04	3.05	
TOTALS .....						34.38	29.42	21.94	25.56	27.22	

c c c c c



RAINFALL AT Canterbury

Mr. Jas Reid 11 Bridge Street Bridge St

Rain { By.....  
Gauge { Diameter.....5.....in.

Height above Ground, ..... ft. 10... in.

Above Mean Sea Level, ..5.1.... ft.

2. Stour.

YEAR.....						1865	1866	1867	1868	1869	MEANS.
January .....							3.83	3.62	3.88	2.72	
February .....							4.36	1.52	1.80	3.37	
March .....					#	.51	2.95	3.19	1.32	3.09	
April .....						.28	2.66	1.49	2.07	1.67	
May .....						2.14	1.09	3.44	1.25	4.47	
June.....						1.30	2.63	1.18	.52	1.10	
July .....						2.46	2.76	3.04	.86	.39	
August.....						3.57	2.84	.78	2.84	1.37	
September ...						.43	4.54	1.66	2.64	3.33	
October.....						9.42	.79	1.48	2.16	2.33	
November.....						3.72	2.17	1.71	2.71	1.91	
December.....						1.64	1.90	1.99	5.20	3.41	
TOTALS .....							32.52	25.10	27.25	29.16	

C C C C C

In centre of square walled garden, Houses on SW may slightly affect results in windy weather.



# RAINFALL AT *Stourmouth Rectory - Kent*

Observer *Rev<sup>d</sup> R. Drake*

Rain { By.....  
Gauge { .....  
Diameter.....in. Height above Ground,.....ft.....in. Above Mean Sea Level.....ft.

*J. Stour.*

YEAR.....	1860	1861	1862	1863	1864	1865	1866	1867	1868	1869	MEANS.
January.....	.76	.23	.35	.36					3.10	1.67	
February.....	.22	.16	.10	.93					1.16	2.96	
March.....	.58	.33	1.67	.48					.99	2.70	
April.....	.22	.25	1.38	.40					2.30	1.76	
May.....	.25	.52	1.27	.43					.81	3.65	
June.....	.95	1.46	.74	1.03					.59	.72	
July.....	3.03	.93	.64	.08					.77	.22	
August.....	2.50	1.12	.85	2.09					2.00	1.32	
September.....	2.27	3.75	1.51	1.44					1.64	3.64	
October.....	.97	.19	2.02	1.51				1.40	1.89	2.46	
November.....	1.86	5.53	.30	.60				1.19	2.13	2.18	
December.....	.50	.65	.37					1.85	3.92	2.48	
TOTALS.....	14.11	15.12	11.20						21.30	25.76	

1860-63 Gauge on roof with pipe leading to dial below.

1863 Gauge found choked with a birds nest

1867 New gauge by Nepecki & Zambra



RAINFALL AT Ramsgate

1/2 Inch Smiles

2 Nelson Terrace Greenwich

Rain { By .....  
Gauge { Diameter.....5.....in.

Height above Ground, 7... ft. 4.. in.

Above Mean Sea Level, ..... ft.

2. Stour.

YEAR.....								1867	1868	1869	MEANS.
January .....								2.25	2.88		
February .....								.88	1.03		
March .....								1.74	1.02		
April .....								1.12	1.00		
May .....								2.93	.70		
June.....								.61	.96		
July .....								2.08	.29		
August.....								.38	.95		
September ...								.52	} 3.40		
October.....								1.50			
November.....								.90	} 4.81		
December.....								2.09			
TOTALS .....								17.00	17.04		

c c



RAINFALL AT Ramsgate  
Royal Harbor House

Capt Shaw

Rain { By .....  
 Gauge { Diameter.....12.....in.

Height above Ground, 32 ft. .... in.

Above Mean Sea Level, 53 ft.

2. Stair.

YEAR.....								1867	1868	1869	MEANS.
January .....								# .53			
February .....								.60			
March .....								.90			
April .....								.63			
May .....								3.41			
June.....								.70			
July .....								1.67			
August.....								.57			
September ...								.67			
October.....								1.19			
November.....								.69			
December.....								1.60			
TOTALS .....								13.16			

C



Trafalgar Place  
 Romsgate  
 Chas J Fowler

2. Scour.

YEAR - -	1860	1861	1862	1863	1864						MEANS.
January - -	1.50										
February - -	1.10										
March - - -	1.20										
April - - -	2.00										
May - - - -	2.50										
June - - - -	3.20										
July - - - -	1.47										
August - - -	2.51										
September -	4.60										
October - - -	1.44										
November -	2.73										
December -	3.14										
TOTALS -	35.00										

C

1860 Sept 24-25 1.37 ; 28-29 2.45 in 28 hours.



# RAINFALL AT Namsgate Cannon Brewery

By Dr. Robert Cramp

Rain { By 12.67  
Gauge { Diameter 10 in.

Height above Ground, 7 ft. 6 in.

Above Mean Sea Level, 7.8 ft.

*J. S. Cochr.*

YEAR .....	1860	1861	1862	1863	1864	1865	1866	1867	1868	1869	MEANS.
January .....		.64	1.09	2.49	1.43	3.16	2.54	2.48	2.49		
February .....		1.24	.32	1.05	1.19	1.60	3.04	.80	.64		
March .....		1.29	4.29	.64	1.97	1.49	1.84	2.01	1.42		
April .....		.67	2.29	.43	.57	.30	1.55	.90	1.25		
May .....	<sup>x</sup> 4.38	1.57	2.68	1.58	2.18	1.90	1.20	4.13	1.21		
June .....	3.69	1.16	2.14	2.87	1.19	.75	2.47	.54	.89		
July .....	1.70	1.60	2.54	.50	.40	3.62	2.70	2.44	.79		
August .....	2.49	1.53	1.37	2.02	2.28	4.09	3.21	.75	1.50		
September ...	5.39	2.67	2.39	2.87	1.79	.39	3.22	.78	1.94		
October .....	1.54	1.01	3.92	3.03	1.34	6.70	.32	1.34	1.43		
November ...	3.06	6.00	.70	1.74	3.06	3.86	2.04	1.07	1.81		
December .....	3.47	1.44	1.00	1.50	.84	.87	1.37	2.13	3.15		
TOTALS .....		20.82	25.53	20.72	18.24	28.73	25.50	19.37	18.52		

c c c c c c c c c c

1868 May 29<sup>th</sup> 30<sup>th</sup> Very heavy storm from 6.3 P.M. on 29<sup>th</sup>  
to 2 A.M. on 30<sup>th</sup>



# Rainfall at Acot, Margate

60

Edw. S. Lendon.

51 - 20 - N

1 - 18 - E

70 - 65

Diameter of Gauge, 5 in.

Height above Ground, 1 ft. .... in.

Above Mean Sea Level, ..... ft.

Gasella B.A

2 - 30 - 1860

YEAR - -	1860	1861	1862	1863	1864	1865	1866	1867	1868	1869	MEANS.
January - -					# .49	3.23	2.99	2.04	2.85	1.79	
February - -					.96	1.62	3.51	1.11	1.17	2.97	
March - - -					1.89	1.63	2.35	2.26	1.10	2.12	
April - - -					.71	.39	1.92	1.29	1.51	1.74	
May - - - -					1.90	2.60	1.13	4.36	1.12	2.24	
June - - - -					1.08	.53	2.44	2.84	.89	.75	
July - - - -					.48	2.82	3.42	2.40	.72	.29	
August - - -					2.21	4.48	3.17	1.29	2.34	1.07	
September -					1.42	.32	3.52	1.29	1.81	1.75	
October - -					1.04	6.75	.42	1.43	1.69	2.22	
November -					2.92	3.61	2.10	1.22	2.05	1.64	
December -					.74	1.82	1.49	1.67	4.26	2.02	
TOTALS -					15.84	29.80	28.46	23.20	21.51	20.60	

1864 A very dry year



RAINFALL AT Margate

*Royal Sea Bathing Infirmary*  
*W. H. Jones*

Rain { By .....

Gauge { Diameter.....in.

Height above Ground, ..... ft. .... in.

Above Mean Sea Level, ..... ft.

*J. Stow.*

YEAR .....	1860	1861	1862	1863	1864	1865	1866	1867	1868	1869	MEANS.
January .....						#2.69					
February .....						1.64					
March .....						1.67					
April .....						31					
May .....						1.65					
June .....						.52					
July .....						3.21					
August .....						5.27					
September ...						.25					
October .....						5.74					
November ...						2.84					
December .....						2.11					
TOTALS.....						27.90					

*c*



RAINFALL AT Margate (Blossams Green)  
Kent

Observer W. Lane Sear Esq.

Rain { By.....  
Gauge { Diameter 5 in.

Height above Ground, h ft. .... in.

Above Mean Sea Level 3.5 ft.

2 - Stour.

YEAR.....										1869	MEANS.
January.....										<del>1</del> 1.76	
February .....										1.75	
March.....										2.23	
April.....										1.39	
May .....										2.83	
June.....										.55	
July .....										.18	
August.....										1.15	
September.....										2.57	
October .....										2.30	
November.....										2.05	
December.....										2.05	
TOTALS .....										20.81	

c



RAINFALL AT JavershamRev W A Proton Otterden Rectory, CharingRain { By .....  
Gauge { .....  
Diameter.....5.....in.

Height above Ground, 1... ft. .... in.

Above Mean Sea Level, 507... ft.

3. Swale.

YEAR.....	1860	1861	1862	1863	1864	1865	1866	1867	1868	1869	MEANS.
January .....	3.63	.61	1.69	3.00	.82	4.60	4.11	3.03	3.95	2.77	2.829
February .....	1.54	1.77	.85	.89	1.18	2.28	4.16	1.46	1.36	2.96	1.845
March .....	3.00	2.44	4.65	1.11	3.00	2.36	2.40	3.28	1.27	2.30	2.581
April .....	2.96	.67	1.97	.80	.67	.37	2.19	1.55	2.47	1.32	1.497
May .....	3.77	1.19	3.13	1.61	2.49	3.15	1.58	3.28	1.16	4.19	2.555
June.....	4.81	2.57	2.62	3.11	1.26	1.43	2.94	1.34	.35	.91	2.134
July .....	1.87	2.32	1.25	.80	.51	3.61	2.79	5.51	.54	.37	1.957
August.....	4.08	1.17	3.29	1.61	2.39	3.59	3.93	1.51	2.97	1.92	2.646
September ...	5.05	3.14	1.96	3.31	2.53	.14	4.78	1.66	2.54	3.78	2.889
October.....	2.16	1.10	4.53	2.67	1.26	8.84	1.03	2.18	2.43	2.19	2.839
November.....	3.24	6.23	1.08	2.03	5.64	3.45	2.20	1.00	2.19	2.44	2.950
December.....	2.48	2.12	2.57	2.01	.74	1.44	1.71	1.24	5.75	3.61	2.367
TOTALS .....	38.59	25.33	29.59	22.95	22.49	35.34	33.82	27.04	26.98	28.76	29.089

c c c c c c c c c c c



RAINFALL AT JavershamHarefield SellingEdwin Neales

Rain { By .....

Gauge { Diameter.....5.....in.Height above Ground, 2... ft. 6... in.Above Mean Sea Level, 217... ft.3- Swale.

YEAR.....							1866	1867	1868	1869	MEANS.
January .....								3.50	3.42	2.75	
February .....								1.22	1.27	2.48	
March .....							2.87	2.67	1.05	1.65	
April .....							2.33	1.23	1.88	1.22	
May .....							1.74	3.10	.76	3.43	
June.....							2.66	1.41	.23	.90	
July .....							2.19	4.02	.54	.26	
August.....							3.23	1.12	2.66	1.62	
September ...							4.52	1.54	2.44	3.15	
October.....							.96	1.94	2.29	2.10	
November.....							1.93	1.28	2.40	2.22	
December.....							1.42	1.46	4.88	3.58	
TOTALS .....								24.49	23.82	25.56	

c c c c

1868 Aug. 17<sup>th</sup> 1 inch fell in 1.20



# RAINFALL AT Faversham

Walter C Stunt

Brogdale

Rain { By .....  
 Gauge { Diameter.....5.....in.      Height above Ground, ..... ft. 7... in.      Above Mean Sea Level, ..... ft.

3. Swale.

YEAR.....							1866	1867	1868	1869	MEANS.
January .....							3.78	3.01	3.77	3.01	
February .....							3.60	1.47	1.16	2.91	
March .....							2.28	2.58	1.09	2.14	
April .....							2.24	1.15	2.09	1.13	
May .....							1.77	3.03	.94	3.91	
June.....							2.37	1.18	.31	.65	
July .....							2.29	3.92	.54	.31	
August.....							3.70	1.01	2.45	2.41	
September ...							3.80	1.41	2.68	3.24	
October.....							.94	1.64	2.01	2.39	
November.....							1.75	1.22	1.85	2.15	
December .....							1.30	1.24	5.21	3.90	
TOTALS .....							29.82	22.86	24.10	28.15	

c c c c



Rainfall at Milstead, Sittingbourne

Wm Bland Esq Sir J. M. Tylden

Rather sheltered by a hedge

Diameter of Gauge, 5 1/2 in.

Height above Ground, 1 ft. 6 in.

Above Mean Sea Level, 23 1/2 ft.

3. Sussex. Howards bottle gauge

YEAR - -	1860	1861	1862	1863	1864	1865	1866	1867	1868	1869	MEANS.
January - -	3.79	.61	2.91	3.12							
February - -	1.78	1.35		1.10							
March - - -	2.39	2.84	7.53	.72	3.26						
April - - -	3.10	1.09		.53	.26						
May - - - -	2.64	2.74	2.76	1.86	2.04						
June - - - -	5.15			3.25	1.50						
July - - - -	2.45	2.56	5.20	.70	.79						
August - - -	4.34	1.78		1.37	1.37						
September -	5.18	.47	4.50	3.42	3.42						
October - -	2.43	5.69		2.11	1.52						
November -	3.10		1.53	2.21							
December -	2.40	3.31	2.34								
TOTALS -	39.05	22.44	26.77								

c c c c c



# Rainfall at. Sittingbourne Tong.

60

George H. Esq.

Barometer 5 in.

3. Scale.

2 ft 6 in. + ground 2 ft. 6 in. + sea level 12 ft

YEAR - -	1860	1861	1862	1863	1864	1865	1866	1867	1868	1869	MEANS.
January - -	2.70	.17	1.40	2.64	.60	4.10	3.63	2.75	3.57		
February - -	1.41	1.54	.85	1.00	1.08	2.15	3.63	1.25	1.25		
March - - -	2.25	2.22	2.84	.75	2.93	1.76	1.89	3.08	1.21		
April - - - -	2.35	.71	3.84	.75	.63	.34	2.54	1.35	1.68		
May - - - - -	3.31	1.18	1.47	1.48	1.86	3.05	1.60	2.87	1.24		
June - - - - -	4.03	1.87	2.00	4.30	1.69	1.13	2.57	1.80	.27		
July - - - - -	2.37	1.78	1.43	.61	.48	4.01	2.36	4.54	1.02		
August - - -	3.20	.80	2.22	1.27	2.01	4.33	2.77	1.01	2.03		
September -	2.19	1.40	2.41	2.77	2.82	.33	4.10	1.35	2.74		
October - - -	1.87	.53	3.80	1.91	1.30	7.54	1.08	1.74	2.04		
November -	2.74	5.70	1.87	2.06	3.98	3.37	1.92	1.02	1.81		
December -	2.19	1.26	2.32	2.07	.38	1.67	1.35	1.62	4.56	#	
TOTALS -	31.21	19.16	26.45	21.61	19.96	33.98	29.52	24.38	23.42		

c c c c c c c c c c

Gauge in rock work hollyhedge 16 ft S. 5 ft high.  
 Spring hedge 9 " W 4 " "



# RAINFALL AT Verne Bay 13 St Georges Terrace

Observer... H. Dorat Esq....

Rain { By.....

Gauge { .....  
Diameter.....in.

Height above Ground, 1 ft. — in.

Above Mean Sea Level 3 ft.

3 - Sale.

YEAR.....										1868	MEANS.
January.....											
February .....											
March .....											
April.....										# .96	
May .....										.95	
June.....										.60	
July .....										1.33	
August.....										1.23	
September.....										1.88	
October .....										#	
November.....											
December .....											
TOTALS .....											

C



# RAINFALL AT Sheerness (Water Works)

60

Rain { By J Lund  
Gauge {

1 67

Diameter.....in.

Height above Ground, ..... ft. 3 in.

Above Mean Sea Level, ..... 9 ft.

5-Swale.

YEAR .....	1860	1861	1862	1863	1864	1865	1866	1867	1868	1869	MEANS.
January .....							3.26	1.91	3.11		
February .....						# 87	3.40	.95	.77		
March .....						1.41	2.11	2.36	.80		
April .....						.41	2.50	1.41	1.25		
May .....						2.47	1.17	2.60	.92		
June .....						1.32	2.55	1.92	.37		
July .....						3.22	2.80	5.19	.49		
August .....						3.78	3.06	1.52	1.20		
September ...						.06	3.53	1.20	1.46		
October .....						7.16	1.05	1.57	1.89		
November ...						1.56	1.38	.43	1.17		
December .....						1.25	1.28	1.42	3.46		
TOTALS.....						23.51	28.09	22.48	16.89		

c c c c

ly on grass plot E. Office 25 ft. high, 33 ft. distant, to  
N wall 4 ft. 6 high & 20 ft. distant, E & S open



RAINFALL AT Sherrings (Water Works)

Rain } By J Lund  
Gauge { Diameter.....in.      Height above Ground, 70 ft. 67 in.      Above Mean Sea Level, 79 ft. 67 in.

3- Swale.

YEAR .....	1860	1861	1862	1863	1864	1865	1866	1867	1868	1869	MEANS.
January .....							.93	.59	1.46		
February .....							1.92	.51	.40		
March .....						<del>.25</del> .05	.69	.70	.29		
April .....						.26	1.14	.61	.53		
May .....						1.44	.70	1.84	.58		
June .....						.78	1.98	1.49	.16		
July .....						2.10	2.10	3.38	.28		
August .....						2.26	1.95	1.10	.56		
September ...						.03	2.11	.84	.67		
October .....						3.97	.64	1.06	.97		
November ...						.46	.82	.11	.46		
December .....						.54	.81	.63	1.48		
TOTALS .....						11.89	15.79	12.86	7.84		

c c c c

from water tower



RAINFALL AT *The Nore Light Ship*

Observer *W. Bartlett*

Rain { By.....  
Gauge { .....  
Diameter.....in.

Height above *Deck* Ground, *2* ft. *5* in. Above ~~Mean~~ Sea Level *8* ft.

*3 - Swale*

YEAR.....	1860	1861	1862	1863	1864	1865	1866	1867	1868	1869	MEANS.
January.....							.89	.90			
February.....							2.55				
March.....							1.20	1.82			
April.....							2.56				
May.....							.86	2.49			
June.....							1.88				
July.....							1.38	4.28			
August.....							2.95				
September.....							2.33				
October.....							.48				
November.....						<i>#</i>	1.09				
December.....						<i>#</i> .51	1.22				
TOTALS .....							19.39				

*1865 Observations commenced Decr 10th*



RAINFALL AT Cranbrook

Genl. Pile Jan

Hartley

51° 5' N

0° 30' E

Rain { By .....  
Gauge { Diameter.....5.....in.

Height above Ground, 4... ft. 4... in.

Above Mean Sea Level, 35.2 ft.

4" midway

YEAR.....						1866	1867	1868	1869	MEANS.
January .....						<del>4.25</del> <del>4.94</del>	4.12	4.74	3.82	
February .....						<del>4.35</del> <del>4.66</del>	1.93	1.46	3.26	
March .....						<del>2.03</del> <del>1.87</del>	3.24	1.49	2.45	
April .....						<del>1.99</del> <del>2.15</del>	1.94	1.85	1.51	
May .....						<del>1.66</del> <del>86</del>	3.09	1.01	4.57	
June .....						<del>2.80</del> <del>3.46</del>	1.23	.50	1.15	
July .....						<del>2.55</del> <del>2.52</del>	4.51	2.50	.37	
August .....						<del>3.32</del> <del>3.43</del>	1.88	4.40	1.24	
September ...						<del>5.63</del> <del>5.68</del>	1.84	2.97	4.37	
October .....						<del>1.73</del> <del>1.74</del>	3.10	2.90	2.48	
November .....						<del>2.34</del>	1.65	2.17	2.02	
December .....						<del>2.16</del>	2.62	7.08	4.25	
TOTALS .....						<del>34.81</del> <del>35.77</del>	31.15	33.07	31.49	

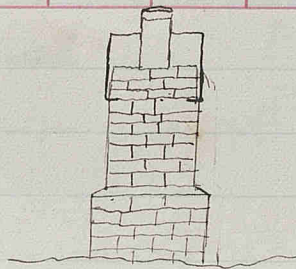

1866 cont for W.D. by copy of A rec. 1917.



Rainfall at Cranbrook

Tillotson

Thomas Pile Esq

Contracted float with dipping rod

Diameter of Gauge, ..... in.      Height above Ground, .A... ft. <sup>4</sup> <sub>69</sub> in.      Above Mean Sea Level, ..... ft.

4 - midway.

YEAR - -			1862	1863	1864	1865	1866	1867	1868	1869	MEANS.
January - -				4.13	1.05	6.09	5.34	6.24	6.10	4.15	
February - -				1.13	1.57	4.41	5.21	1.93	1.46	5.39	
March - - -		#	4.83	1.17	3.71	2.46	2.20	3.72	2.14	2.96	
April - - -			2.50	.80	.53	.29	1.86	1.97	2.07	1.54	
May - - - -			2.26	2.46	2.61	2.77	2.77	2.96	.94	5.12	
June - - - -			2.38	4.66	1.17	1.05	2.07	1.76	.52	1.24	
July - - - -			1.40	.84	.71	5.08	2.90	5.11	3.00	.36	
August - - -			2.67	2.41	1.86	4.06	3.76	2.33	4.63	1.37	
September -			2.44	4.85	3.44	.02	6.74	2.14	3.23	5.15	
October - - -			6.07	3.03	2.24	11.81	1.29	3.42	3.23	2.33	
November - -			.87	1.97	7.43	4.29	2.82	1.16	2.55	2.34	
December - -			3.28	2.78	1.57	2.05	2.80	3.79	9.53	5.35	
TOTALS -				30.13	27.83	44.38	39.76	36.53	39.60	37.30	

Fac. Simile of Sketch

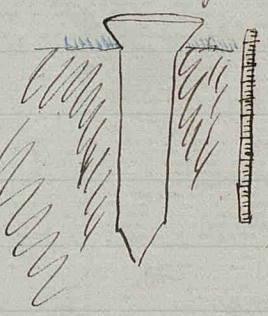



Scotney Castle  
Lamberhurst

Edw<sup>d</sup>. Huxey

+ ground 4 ft

+ Sea Level

at midway.

YEAR - -	1860	1861	1862	1863	1864	1865	1866	1867	1868	1869	MEANS.
January - -			1.87	2.91	.94	3.87					
February - -			.85	.90	.94	1.77					
March - - -			{ 6.63 }		2.97	1.84					
April - - - -				50	.83	.20					
May - - - -			3.10	1.96	2.53	2.68					
June - - - -			2.49	4.22	1.60						
July - - - -			1.03	.79	.34						
August - - -			3.48	2.27	1.85						
September -			1.11	4.23							
October - -				2.26							
November -			{ 2.94 }	3.06							
December -				.42	2.09						
TOTALS -			223.50								

1 c c c c

1863. I think March is included in April but  
am not quite certain and from 1864  
but there was not any at all, a small  
quantity for a year or two but not for the rest  
of the year.



# Lamberhurst The Court Lodge Kent

W. C. Morland

3 ft  
+ ground 3 ft 6

200' 64  
300'

4 - medusa.

YEAR - -	1860	1861	1862	1863	1864	1865	1866	1867	1868	1869	MEANS.
January - -			# 1.47	3.34	1.07						
February - -			.90	1.32	1.14						
March - - -			4.46	.86	3.64						
April - - - -			.97	.84	.90						
May - - - -			3.15	2.01	2.31						
June - - - -			2.87	4.24							
July - - - -			1.41	.76							
August - - -			2.73	2.29	6.19						
September -			1.98	3.46							
October - -			5.70	2.79	2.22						
November -			1.03	2.72	5.79						
December -			2.88	1.50	.97						
TOTALS -			29.55	26.13	24.23						

? c c c

1864 A year of excessive drought (but not of heat) from June 20<sup>th</sup> to Aug. 27 only 1.63 in. of rain, and from 23<sup>rd</sup> of Sep<sup>r</sup> to 17<sup>th</sup> of Oct<sup>r</sup> there was not any at all, a most favorable season for agriculture though not for the root crops



Rainfall at Gusshurst

W. J. M. Stearns

Staplehurst

Diameter of Gauge, 5 in.

Height above Ground, 1 ft. 1 in.

Above Mean Sea Level, 33.5 ft.

4 - medway.

YEAR - -						#				MEANS.
						1866				
January - -						# 4.53				
February - -						4.43				
March - - -						1.82				
April - - -						1.85				
May - - - -						1.41				
June - - - -						2.65				
July - - - -						2.60				
August - - -						3.22				
September -						4.87				
October - - -						1.40				
November - -						2.45				
December - -						1.81	#			
TOTALS -						33.04				

C



Rainfall at Goudhurst Vicarage  
Staplehurst

Rev. Mr. Clarke

51° 6' 28" N  
 0° 28' 10" E

Diameter of Gauge, 5 in.

Height above Ground, 1 ft. 3 in.

Above Mean Sea Level, 41.9 ft. O.S.D.

4 - Medway

YEAR - -						1866	1867	1868	1869	MEANS.
January - -							3.82	4.21	2.67	
February - -							1.71	1.16	2.41	
March - - -							2.56	1.07	1.90	
April - - -							1.44	2.06	1.32	
May - - - -							2.22	1.51	4.80	
June - - - -							.54	.46	.74	
July - - - -							3.56	2.32	.54	
August - - -							1.44	3.17	1.09	
September -							1.50	3.19	3.01	
October - - -							2.56	2.19	2.62	
November -							1.41	1.61	2.07	
December -							1.75	4.64	3.94	
TOTALS -							24.57	29.59	27.11	

c c c



RAINFALL AT Lunbridge Wells

Rev J W Stow

Garden Villa

Rain { By .....  
Gauge { Diameter 4.5 in. Height above Ground, ..... ft. 6 in. Above Mean Sea Level, 403 ft.

L - midway

YEAR.....								1867	1868	1869	MEANS.
January .....								#4.43	4.95		
February .....								*2.05	1.49		
March .....								*3.57	1.29		
April .....								1.81	2.35		
May .....								1.98	.91		
June.....								2.10	.50		
July .....								4.60	2.71		
August .....								1.66	3.54		
September ...								1.74	2.98		
October.....								2.81	2.57		
November.....								1.41	1.91		
December .....								2.62	7.46	#	
TOTALS .....								(30.78)	32.66		

C C

1867 the months marked thus + were furnished by a friend whose gauge generally gives the same results as my own



# RAINFALL AT *S<sup>t</sup> Stephens Tonbridge* *Kent*

Observer...*W. C. Punnett*.....

Rain { By.....  
Gauge { Diameter.....*5*.....in. Height above Ground, *2*.....ft.....in. Above Mean Sea Level...*98*<sup>↑</sup>.....ft.

*4 - medley*

YEAR.....	1860	1861	1862	1863	1864	1865	1866	1867	1868	1869	MEANS.
January.....									3.12	3.24	
February .....									.96	2.48	
March .....									1.07	1.64	
April .....									1.94	1.02	
May .....									.30	3.99	
June .....									.22	.71	
July .....									1.74	.26	
August .....									3.48	.85	
September.....									2.23	4.48	
October .....									2.25	2.54	
November.....									1.94	2.46	
December .....									5.45	3.77	
TOTALS .....									24.70	27.44	

*C C*



Tunbridge

C.Z

41

by J Fielding M.D. &amp;c.

Map Ref No 26

71.15-67

(0.5.0)

Drain 5 in on the ground 1 ft + Sea level 125 feet

u. - medway

YEAR - -	1860	1861	1862	1863	1864	1865	1866	1867	1868	1869	MEANS.
January - -	2.04	.40	1.80	2.61	.74	2.80	5.85	3.15	3.70	3.27	2.744
February - -	1.17	1.75	.69	1.12	1.16	2.13	5.90	1.87	1.00	3.25	2.004
March - - -	2.55	2.19	3.79	.74	3.42	1.91	2.23	2.61	1.91	2.46	2.381
April - - -	2.75	.62	1.93	.54	.88	.36	2.12	1.67	2.04	1.82	1.473 -
May - - - -	2.79	1.56	2.21	1.78	1.76	3.64	10.1	1.70	.76	4.04	2.125
June - - - -	5.06	2.08	2.52	4.51	1.22	1.19	4.00	1.62	.43	.98	2.361
July - - - -	2.49	2.00	1.32	.83	.51	4.48	3.03	4.69	1.71	.15	2.201
August - - -	3.52	1.00	2.43	1.80	1.18	4.04	1.88	1.89	3.50	1.21	2.325
September -	2.48	2.08	3.03	3.12	3.21	.02	6.04	1.54	1.91	3.73	2.716
October - -	1.75	1.09	4.78	2.64	1.63	7.06	1.37	2.44	2.02	2.78	2.836 +
November -	2.44	5.87	.87	1.87	4.65	2.70	2.19	.92	1.89	2.79	2.627
December -	2.39	1.67	2.17	1.72	1.05	1.74	1.59	2.61	6.10	3.61	2.465
TOTALS -	31.43	23.11	27.62	23.28	21.41	34.75	37.21	26.71	26.97	30.09	28.258.

✓ c ✓ c ✓ c ✓ c ✓ c ✓ c ✓ c ✓ c



Rainfall at New Falconhurst  
nr Edenbridge, Kent.

Jn<sup>r</sup> G. Talbot

Diameter of Gauge, ...5..... in.      Height above Ground, ..... ft. .... in.      Above Mean Sea Level, 11.00 ft.

*at Medway*

YEAR - -	1860	1861	1862	1863	1864	1865	1866	1867	1868	1869	MEANS.
January - -					7.24	3.30	5.60	4.24	4.43	3.92	
February - -					.69	2.24	5.32	1.86	1.58	2.78	
March - - -					3.86	1.44	2.11	3.23	1.49	2.14	
April - - -					.99	.34	1.84	2.05	2.26	1.49	
May - - - -					1.63	3.92	1.13	2.77	.89	4.07	
June - - - -					1.11	1.38	3.50	1.48	.38	1.22	
July - - - -					.36	2.74	3.66	5.00	2.37	.33	
August - - -					1.02	5.05	2.03	1.84	2.85	1.06	
September -					2.79	.01	7.97	1.86	2.87	4.96	
October - -					1.65	9.45	1.73	2.97	2.44	2.59	
November -					4.74	3.72	2.39	.85	1.39	3.57	
December -					1.45	1.82	1.99	2.37	6.76	4.43	
TOTALS -					21.53	35.49	39.35	29.42	29.71	32.56	

c c c c c c c

1868 Almost constant T & L from midnight on the 11<sup>th</sup> to midnight on the 12<sup>th</sup> of July and very violent from 2 to 4 AM on the 12<sup>th</sup>, also a sharp E on 29<sup>th</sup> May T in forenoon of Dec. 24<sup>th</sup>







RAINFALL AT East Sutton Park, Maidstone  
Staplehurst

By Mr. J. H. Skinner

Rain Gauge { By .....  
Diameter 8 in. Height above Ground, 1 ft. .... in. Above Mean Sea Level, ..... ft.

6-67

4- Medway.

YEAR .....	1860	1861	1862	1863	1864	1865	1866	1867	1868	1869	MEANS.
January .....						#4.00	4.02	3.19	3.98	2.66	
February .....						2.24	4.48	1.46	1.15	2.56	
March .....						1.77	1.67	3.08	1.33	2.88	
April .....						.39	1.95	1.52	1.87	1.39	
May .....						2.84	.79	2.78	1.06	3.56	
June .....						1.48	3.66	1.21	.37	.94	
July .....						3.54	4.49	4.99	.55	.38	
August .....						4.65	3.01	1.48	2.29	1.89	
September ...						.03	4.27	1.39	2.81	3.68	
October .....						9.28	1.10	2.55	1.97	2.00	
November ...						3.14	2.06	1.11	1.63	2.00	
December .....						1.44	1.43	2.20	4.93	3.33	
TOTALS .....						35.68	32.93	26.96	23.94	27.27	

c c c c c



Hinton Loist, Maidstone  
Staplehurst Kent

P Goodland

8 in

+ ground 6 in

+ Sea Level

4 - med. say

YEAR - -	1860	1861	1862	1863	1864	1865	1866	1867	1868	1869	MEANS.	
January - -	3.37	.22	1.48	2.55	.54	4.06	4.55	3.28	3.68	2.86	2.659	+
February - -	1.16	1.73	.73	.66	1.14	1.93	4.62	1.54	1.28	2.50	1.729	
March - - -	1.93	2.35	3.05	.49	2.62	1.70	2.42	3.02	1.21	2.51	2.210	
April - - - -	2.52	.83	2.07	.62	.63	.27	2.09	1.47	1.43	1.31	1.324	-
May - - - -	3.03	1.13	2.51	1.62	2.05	3.08	1.26	2.16	1.49	4.20	2.253	
June - - - -	4.63	2.17	2.36	4.94	1.29	.92	2.40	1.02	.46	.90	2.109	
July - - - -	1.71	1.65	1.49	.69	.59	3.69	2.46	4.35	.82	.17	1.762	
August - - -	2.80	.90	2.31	1.54	1.08	4.57	1.98	1.54	2.24	1.07	2.003	
September -	2.59	2.14	2.16	3.27	2.53	.02	4.57	1.43	2.59	4.25	2.555	
October - -	1.60	.91	4.49	1.82	1.31	7.81	1.06	2.71	2.02	2.65	2.638	
November -	2.64	6.07	.94	1.61	4.33	2.59	1.86	1.12	1.91	2.10	2.517	
December -	2.40	1.59	1.66	1.50	.94	1.67	1.51	2.10	5.36	3.66	2.239	
TOTALS -	30.38	21.69	26.05	21.31	19.05	32.31	30.78	25.74	24.49	28.18	25.998	

✓ c ✓ c ✓ c ✓ c ✓ c ✓ c ✓ c ✓ c



Rainfall at East Peckham

Orchard Cottage

Saml. Thos. Harris

Diameter of Gauge, 5 in.      Height above Ground, 2 ft. 65 in.      Above Mean Sea Level, 69 ft. 76 65 69

L - Medway N & S

YEAR - -				1864	1865	1866	1867	1868	1869	MEANS.
January - -					3.18	3.54	2.78	3.68	3.32	
February - -					2.39	4.60	1.43	1.31	2.31	
March - - -					1.60	1.81	2.62	1.25	2.23	
April - - -				#	.57	.20	2.34	1.58	1.42	1.28
May - - - -					1.72	3.83	1.30	1.67	.58	3.87
June - - - -					.87	1.27	2.82	1.34	.36	.91
July - - - -					.77	3.57	2.36	4.33	1.16	.08
August - - -					1.39	4.18	1.28	1.48	2.23	.95
September -					2.70	.00	4.03	1.92	2.32	5.07
October - -					1.51	7.32	.99	2.09	1.85	2.15
November -					4.23	2.83	1.98	.95	1.81	2.06
December -					.93	1.25	.95	2.02	4.94	3.33
TOTALS -						31.52	28.00	24.21	22.91	27.56

c c c c c c



Rainfall at Larkfield

W  
Rev? R Dimock at Maidstone

Diameter of Gauge, 5 in.      Height above Ground, 3 ft. 5 in.      Above Mean Sea Level, 9.5 ft.

4 - Medusa

YEAR - -	1860	1861	1862	1863	1864	1865	1866	1867	1868	1869	MEANS.
January - -							4.24	2.98	3.88	2.96	
February - -							4.41	1.37	1.23	3.64	
March - - -							2.09	2.70	1.09	2.10	
April - - -							2.15	1.99	.90	1.43	
May - - - -							1.72	1.78	.53	4.21	
June - - - -							4.28	1.92	.59	1.15	
July - - - -						4.90	1.56	5.45	.33	.14	
August - - -						3.35	1.63	1.27	2.22	1.29	
September -						.08	5.97	1.65	1.83	4.36	
October - -						7.10	1.18	2.36	2.30	1.72	
November -						2.79	2.02	1.36	1.79	2.00	
December -						1.69	1.54	1.42	5.98	4.13	
TOTALS -							32.79	26.25	22.67	29.13	

C C C C C



Rainfall at Maudstone (Somerfield)

60

J.F. Dobell Esq - J.H. Holmes Esq  
 Died Jan 1868

Diameter of Gauge, ..... in.

Height above Ground, ..... ft. .... in.

Above Mean Sea Level, ..... ft.

*at Medway*

YEAR - -	1860	1861	1862	1863	1864	1865	1866	1867	1868	1869	MEANS.
January - -	3.30	.48	1.95	3.30	.85	4.30	4.15	3.33	4.30	3.20	
February - -	1.45	2.15	.85	.85	1.60	1.95	5.20	1.55	1.30	3.10	
March - - -	2.88	3.08	5.10	.75	3.45	1.80	2.90	2.85	1.20	2.30	
April - - -	3.30	.90	2.05	.86	.39	.20	2.50	2.05	2.00	1.30	
May - - - -	3.57	1.77	2.45	1.45	2.20	2.60	1.49	2.02	1.00	4.10	
June - - - -	5.00	1.40	2.10	4.30	1.20	1.72	2.95	1.43	.50	1.00	
July - - - -	1.70	3.08	1.30	.70	.50	3.98	2.50	5.75	.40	.20	
August - - -	4.03	.92	2.65	1.20	1.68	3.90	2.00	1.40	2.60	1.25	
September -	3.42	2.15	2.33	3.97	3.15	.13	5.88	1.52	2.50	4.03	
October - - -	1.98	1.20	4.50	1.83	1.50	8.68	1.47	2.25		2.22	
November -	3.00	6.40	1.30	1.90	4.50	3.13	1.90	1.10	3.20	1.90	
December -	2.50	1.95	2.17	2.10	.80	2.17	2.23	1.90	6.10	3.83	
TOTALS -	36.13	24.88	28.75	23.21	21.82	34.56	35.17	27.15		28.43	

On high ground west of the Medway below the town  
 Taken monthly at 9 AM on the 1<sup>st</sup>

1868 Oct - taken but not entered, amount forgotten.

1869 In the centre of the garden on an incline on the N  
 about 15 yards distant are some tall trees, the other sides  
 are open



# RAINFALL AT Maidstone

Boxley Road

Observer.....J. M. Leese.....

Rain { By.....Solomon..... daily 8 am

Gauge { Diameter.....5.....in. Height above Ground,.....1.....ft.....in. Above Mean Sea Level.....170.....ft.

1/2 medway

YEAR.....										1869	MEANS.
January.....										.	
February .....										.	
March .....										# 2.42	
April.....										1.27	
May .....										4.31	
June.....										1.03	
July .....										.17	
August.....										.99	
September.....										* 3.46	
October .....										2.45	
November.....										1.92	
December.....										3.69	
TOTALS .....											

1869 \* the accuracy of Sept. is doubtful as the gauge was blown over in a very high wind during my absence.  
 The gauge is placed in the most open place I could get but not as free from buildings and trees as I could wish  
 3/4 m from Maidstone & 1 m from Somerfield



Maidstone (Faint Road)

J H Barristock

1.3 66

6 ft

7 in

+ ground 15 in 64 + 3 Sea Level 60 feet

u. medusae.

YEAR - -	1860	1861	1862	1863	1864	1865	1866	1867	1868	1869	MEANS.
January - -	2.97	.48	1.74	2.27	.80	3.76	3.39	2.60			
February - -	1.60	1.87	.67	1.00	.82	1.99	4.76	1.35			
March - - -	2.71	2.91	4.53	.74	3.64	1.57	2.18	2.82			
April - - -	3.04	1.00	2.00	.69	.47	.24	2.38	1.61			
May - - - -	3.32	1.10	2.37	1.20	1.91	2.52	1.44	2.01			
June - - - -	5.36	1.70	2.02	4.53	1.50	1.32	2.95	1.19			
July - - - -	1.58	2.92	1.23	.57	.51	3.54	2.61	5.17			
August - - -	3.69	1.15	2.40	1.27	1.68	4.44	2.19	1.51			
September -	2.89	1.97	2.05	3.61	2.87	.01	5.78	1.40			
October - - -	1.63	.75	4.14	1.78	1.39	5.20	1.31	2.43			
November -	2.59	6.31	1.16	1.56	3.95	2.59	1.68				
December -	2.27	1.75	1.85	1.51	.82	1.95	1.63				
TOTALS -	33.65	23.91	26.16	20.73	20.36	29.13	32.30				

✓ ✓ ✓ ✓ ✓ ✓ ✓ ✓  
 ✓ ✓ ✓ ✓ ✓ ✓ ✓ ✓



River Hill Seven OaksJ T Rogers Esq<sup>r</sup>

8 in barometer 69

41.6 69

4 + Ground 9 ft 1.3 68 + Sea Level 520 ft

H. midway.

YEAR - -	1860	1861	1862	1863	1864	1865	1866	1867	1868	1869	MEANS.
January - -	.32	2.09	2.80	.76	3.60	4.57	3.13	4.30	2.94		
February - -	2.27	.59	1.05	.97	2.01	4.33	1.48	.98	3.29		
March - - -	2.01	3.88	.51	3.11	1.43	1.56	2.88	1.97	2.99		
April - - - -	.42	1.98	.41	.82	.36	2.44	1.16	1.94	1.44		
May - - - -	.13	2.87	1.99	1.64	3.49	1.65	1.57	.86	3.60		
June - - - -	1.47	2.62	4.66	1.15	1.15	2.46	1.82	.31	1.49		
July - - - -	2.76	1.82	.81	.56	2.95	2.14	3.29	1.72	.39		
August - - -	.87	2.80	2.10	1.26	4.16	2.46	2.36	3.79	1.31		
September -	1.86	2.12	4.10	2.51	.00	7.38	1.92	1.99	4.65		
October - -	1.04	5.64	2.26	.85	6.79	1.62	3.24	2.82	2.81		
November -	5.23	.99	2.40	3.78	2.78	2.83	.52	1.71	2.97		
December -	1.84	1.91	1.86	1.01	.97	2.02	3.08	6.13	3.66		
TOTALS -	20.22	29.31	24.95	18.42	29.69	34.96	26.45	28.52	31.54		

✓ ✓ ✓ ✓ ✓ ✓ ✓ ✓ ✓ ✓

Gauge on coping of low wall in centre of large  
kitchen garden



# Rainfall at Eastlip, Sittingbourne

60

Wm Bland

Diameter of  $\frac{1}{4}$  in. <sup>sq</sup> T ground 2 ft. T sea level 158

4 - Wednesday

YEAR - -	1860	1861	1862	1863	1864	1865	1866	1867	1868	1869	MEANS.
January - -	2.87	.64	1.54	2.79	.57	4.96	3.97	2.86	3.77		
February - -	1.71	1.63	1.03	1.28	1.37	2.38	4.73	1.18	.89		
March - - -	2.66	2.82	4.50	.97	2.76	1.59	2.57	3.30	.77		
April - - - -	2.62	1.01	2.62	.78	.62	.61	2.87	1.45	1.52		
May - - - - -	3.37	1.48	1.89	1.65	2.35	3.00	2.19	2.90	1.03		
June - - - - -	5.18	1.59	1.76	4.36	1.79	2.00	3.35	1.50	.37		
July - - - - -	1.75	1.67	2.56	.78	.54	4.56	2.93	7.36	.84		
August - - -	2.54	.88	2.00	1.12	2.01	4.06	2.09	1.02	1.39		
September -	4.17	1.45	1.95	3.12	1.93	.16	5.29	1.32	2.17		
October - - -	1.73	.60	3.84	2.64	1.81	9.65	.79	1.63	1.89		
November -	2.96	6.39	1.68	1.75	6.12	3.15	1.63	.81	1.46		
December -	2.87	1.87	2.13	2.12	.82	1.80	1.54	1.51	4.31		
TOTALS -	34.43	22.03	27.50	23.36	22.63	37.92	33.95	26.84	20.41		

Gauge on lawn slightly sheltered by shrubs.

Mr. Bland died on the 6<sup>th</sup> Dec 1869 (see Page)

1864 - agrees with Ind. ret. sent to Mr. G. L. P.



RAINFALL AT *Chatham R. I. Observatory*

Observer.....

Rain { By.....

Gauge { Diameter...*10*...☐...in. Height above Ground,...*1*...ft....in. Above Mean Sea Level...*115*...ft.

*4 - midway*

YEAR.....	<i>1860</i>	<i>1861</i>	<i>1862</i>	<i>1863</i>	<i>1864</i>	<i>1865</i>	<i>1866</i>	<i>1867</i>	<i>1868</i>	<i>1869</i>	MEANS.
January.....										<i># 2.02</i>	
February .....										<i>2.87</i>	
March .....										<i>.96</i>	
April.....										<i>1.12</i>	
May .....										<i>4.43</i>	
June.....										<i>1.10</i>	
July .....										<i>0.08</i>	
August.....										<i>2.82</i>	
September.....										<i>2.52</i>	
October .....										<i>3.35</i>	
November.....										<i>1.95</i>	
December.....										<i>2.77</i>	
TOTALS .....										<i>25.99</i>	

*Observations before 1869 not carefully taken*



RAINFALL AT Stood Kent  
(24 High St)

$\frac{1}{4}$  S of Stood Church

By J. L. Hewitts - F.W. Sandy  
Rain Gauge {  
Diameter 5 in. Height above Ground, 0 ft. 0 in. Above Mean Sea Level, 15? ft.

4 - medusa.

YEAR .....	1860	1861	1862	1863	1864	1865	1866	1867	1868	1869	MEANS.
January .....							3.79	2.56	3.72		
February .....						# 1.83	4.62	1.51	1.35		
March .....						1.57	2.22	3.28	1.03		
April .....						.36	2.60	1.99	1.64		
May .....						2.73	.74	2.48	.45		
June .....						1.54	3.50	1.69	.53		
July .....						3.36	2.97	6.65	1.05		
August .....						3.45	3.67	1.28	1.96		
September ...						.13	5.72	1.28	2.56		
October .....						7.01	.94	2.08	2.32		
November ...						2.84	1.70	.56	1.34		
December .....						1.50	1.53	2.56	4.70	#	
TOTALS .....						26.40	34.00	27.92	22.65		

C C C C

1867 July 26 = 2.50



RAINFALL AT Riverhead Passage n. Sevenoaks

By J B Munro  
Rain Gauge Diameter 4 11/16 in. Height above Ground, 1 ft. 8 in. Above Mean Sea Level, 69 ft.

5-Parent-

YEAR.....						1865	1866	1867	1868	1869	MEANS.
January .....						<del>2.12</del> 3.95	5.92	4.80	6.37	4.05	
February .....						2.50	5.98	1.56	1.85	3.65	
March .....						1.90	2.35	3.50	1.79	2.80	
April .....						.35	1.92	1.87	2.83	1.89	
May .....						4.18	2.12	1.82	.80	4.26	
June.....						1.60	2.80	2.25	.50	1.53	
July .....						3.15	2.30	6.27	1.44	.58	
August.....						4.50	2.76	2.02	3.42	1.42	
September ...						0.00	7.09	1.90	2.52	5.79	
October.....						8.04	1.66	2.70	2.97	2.92	
November.....						4.00	2.55	.92	2.06	3.45	
December .....						2.22	3.68	2.53	8.27	5.00	
TOTALS .....							41.13	32.14	34.82	37.34	

C C C C C



Chertwell, Westorham

J. C. Colquhoun

6 65 86

67 500 646

Casella

3 64

400 63

6 in + ground 8 in

+ Sea Level 450 ft

5-Darent.

YEAR - -	1860	1861	1862	1863	1864	1865	1866	1867	1868	1869	MEANS.
January - -				3.59	.89	3.71	3.76	3.66	3.87	2.85	
February - -				.85	.84	2.62	4.77	2.39	2.20	3.80	
March - - -				.75	2.85	1.80	2.70	3.26	1.74	1.97	
April - - -				.33	1.38	.59	1.33	2.10	1.79	1.87	
May - - -			<i>for 2 hrs</i>	.50	2.13	1.93	3.69	1.20	1.11	.93	2.89
June - - -				2.73	3.72	.86	1.24	3.34	2.19	.11	2.28
July - - -				1.87	.62	.98	4.43	2.39	5.23	3.08	.59
August - - -				3.61	2.34	1.29	5.23	2.17	3.66	3.10	1.98
September -				1.42	4.21	3.64	.10	6.88	1.85	.83	3.66
October - -				6.59	3.15	1.81	6.86	.19	2.10	4.04	3.08
November -				1.83	2.56	3.79	3.93	2.64	1.55	1.66	2.35
December -				2.09	2.20	1.30	2.95	3.04	2.99	6.11	5.03
TOTALS -				26.45	21.56	37.15	34.41	32.09	29.46	32.35	

1863 12<sup>th</sup> & 2<sup>nd</sup> of Dec. a great storm of wind



West Wickham

ad. Bromley Kent

John Shd<sup>r</sup> Austen

12 in

100 63 1.6 68  
1 ft + Ground 64 5

330 65

+ S.I. 300 ft. 65

5-Daunt.

YEAR - -	1860	1861	1862	1863	1864	1865	1866	1867	1868	1869	MEANS.
January - -	3.77	.36	1.69	3.24	.91	3.93	4.48	.63	1.71		
February - -	1.42	.13	1.31	.66		2.49	4.39	2.58	1.20		
March - - -	2.24	3.77	4.40	.81	4.60	1.20	2.53	1.88	.72		
April - - -	1.53	1.10	2.47	.79	.94	.42	2.54	4.55	2.48		
May - - -	3.22	2.28	3.23	2.50	1.86	3.72	2.02	1.25	1.94		
June - - -	5.39	2.19	2.10	3.64	.91	2.29	4.19	2.00	.46		
July - - -	2.46	3.24	1.26	.94	.81	2.03	3.26	5.77	1.72		
August - - -	4.17	.49	3.80	2.07	1.20	4.08	2.96	2.15	2.72		
September -	3.84	1.83	1.67	4.50	3.51	.20	4.50	5.40	2.37		
October - -	2.08	1.15	4.80	2.13	1.61	7.73	.81	2.70	1.87		
November -	3.32	5.83	1.23	3.17	3.30	4.70	2.36	1.26	1.04		
December -	3.31	1.18	2.45	1.86	.91	1.50	2.21	1.66	4.38		
TOTALS -	36.75	23.55	30.41	26.31	20.56	34.29	36.25	31.83	22.61		

C C C C C C C C C



West Wickham

Wm Adams Stewart

Mary Stewart

Newman } + Ground 3 ft

+ Sea Level

5- Parent.

YEAR - -	1860	1861	1862	1863	1864	1865	1866	1867	1868	1869	MEANS.
January - -	#	2.30	1.65	2.37	.60	4.10	3.49				
February - -			.50	.90	.78	2.50	4.10				
March - - -			3.25	.63	2.15	1.03					
April - - -		1.52	1.23	.70	.88	.17					
May - - - -		1.27	3.00	1.40	1.10	3.26	1.35				
June - - - -		2.05	2.00	3.55	1.06	2.25	2.65				
July - - - -		2.15	1.15	.59	.25	2.77	3.00				
August - - -		.68	3.55	1.65	1.33	4.24	3.27				
September -		1.85	1.15	4.05	2.73	.25	4.90				
October - -		1.00	4.00	1.55	.97	7.85	1.83				
November -		5.35	1.00	1.30	2.95	3.76	1.54				
December -		.80	1.62	1.60	.59	1.75	1.47				
TOTALS -		18.97	24.10	20.29	15.39	33.93					

✓ c ✓ c ✓ c ✓ c c c



RAINFALL AT Bromley CommonNew A. Rowson

Rain } By .....

Gauge } Diameter.....8.....in.Height above Ground, 1.... ft. 3... in.Above Mean Sea Level, 282.... ft.250 67 695-Parent.

YEAR .....	1860	1861	1862	1863	1864	1865	1866	1867	1868	1869	MEANS.
January .....						3.19	4.94	2.12	4.44	3.60	
February .....						2.47	4.56	1.33	1.66	3.15	
March .....						1.29	1.92	2.99	1.20	2.09	
April .....						1.51	2.66	2.58	1.90	1.46	
May .....						3.57	1.83	1.79	.82	3.29	
June .....						1.51	2.67	1.75	.31	1.36	
July .....						2.60	2.27	5.17	1.64	.56	
August .....						4.36	2.41	2.35	2.45	1.00	
September ...						.10	5.15	1.76	3.35	3.65	
October .....						6.95	1.50	1.91	2.21	1.95	
November ...						3.00	1.45	.71	1.51	2.42	
December .....						1.57	1.91	1.70	4.93	3.35	
TOTALS.....						31.12	33.27	26.16	26.42	27.88	

C C C C C







RAINFALL AT W. Bromley Garden Lodge Bickley  
Kent

G. J. Chambers S. R. A.

Rain { By Basella

240.69

Gauge { Diameter 5 in.

Height above Ground, 1 ft. 0 in.

Above Mean Sea Level, 220 ft.

5-Darent

YEAR .....								1867	1868	1869	MEANS.
January .....							#	2.46	3.95	1.71	
February .....								1.48	.54	2.56	
March .....								2.34	1.66	1.68	
April .....								2.23	1.48	1.33	
May .....								1.77	1.36	2.64	
June .....								1.67	.28	1.41	
July .....								5.04	1.13	.57	
August .....								2.09	2.50	.93	
September ...								1.73	1.54	2.33	
October .....								1.36	2.27	2.07	
November ...								.69	.30	2.37	
December .....								1.52	4.79	2.37	#
TOTALS .....								24.38	21.80	21.97	

c c c

1869 Sep 12 th - G. blown over but believe no r. was lost.



RAINFALL AT Beckenham

60 & 6ator

Kent

Rain { By.....  
Gauge { Diameter.....5.....in.

Height above Ground, ..... ft. 2... in. Above Mean Sea Level, ..157.... ft.

5-Darent

YEAR.....							1866	1867	1868	1869	MEANS.
January .....									# -	3.13	
February .....									1.24	2.43	
March .....						5	1 66		.94	1.51	
April .....							2.25		1.39	1.01	
May .....							2.01		.52	3.15	
June.....							3.51		.21	1.20	
July .....							2.08		1.29	.55	
August.....							2.70		2.59	1.04	
September ...							4.16		1.78	3.02	
October.....							1.77		2.14	1.83	
November.....							1 62		1.10	2.53	
December.....							#		4.25	2.90	
TOTALS .....										24.30	

c c c



# RAINFALL AT Berkenham Parkside C O S Water Kent

Rain { By .....  
Gauge { .....  
Diameter.....2.....in.

Height above Ground, ..... ft. 2 in.

Above Mean Sea Level, 157..... ft.

5-Parent.

YEAR.....							1866	1867	1868	1869	MEANS.
January .....							<sup>4.10</sup> 3.90	2.48	4.25	2.80	
February .....							3.70	1.36	1.24	2.52	
March .....							1.61	2.77	1.02	1.71	
April .....							2.17	2.28	1.49	1.23	
May .....							1.93	1.97	.68	3.37	
June.....							3.52	1.60	.34	1.32	
July .....							1.95	5.12	1.40	.67	
August.....							2.63	2.66	2.94	1.27	
September ...							3.98	2.29	1.82	3.15	
October.....							1.69	1.97	2.16	1.90	
November.....							1.50	.84	1.12	2.53	
December.....							1.89	1.49	4.07	2.95	
TOTALS .....							30.47	26.83	22.53	25.42	

C C C C



RAINFALL AT Parkside Beckenham

Kent

Observer E. J. Gator No 3

Rain { By.....  
Gauge { .....  
Diameter 5 in.

Height above Ground, 5.0 ft. in.

Above Mean Sea Level 200 ft.

5 - Darent.

YEAR.....										1869	MEANS.
January.....										# 2.26	
February .....										1.66	
March .....										.81	
April.....										.86	
May .....										2.88	
June.....										1.10	
July .....										38	
August.....										.73	
September.....										2.28	
October .....										1.50	
November.....										2.28	
December.....										2.36	
TOTALS .....										19.10	

C



# RAINFALL AT Beckersham

Box grove

Observer... Percy Bicknell .....

Rain { By..... Monthly .....

Gauge { Diameter..... 5 .....in.

Height above Ground, 4 .....ft.....in.

Above Mean Sea Level. <sup>7</sup>142 .....ft.

5-Parent.

YEAR.....									1868	1869	MEANS.
January.....										3.23	
February .....										2.72	
March .....										1.45	
April.....										1.22	
May .....									<del>#</del> .67	3.09	
June.....									.08	1.25	
July .....									1.10	.61	
August .....									2.64	1.25	
September.....									<sup>A</sup> 3.96	3.18	
October .....										1.80	
November.....									1.21	2.44	
December.....									<sup>B</sup> 4.33	3.05	
TOTALS .....										25.20	

About 5 gal. from the other gauge known to <sup>C</sup> ~~5~~ <sup>C</sup>  
 1868 A Sept. & Oct. .074 more than shown by ground gauge measured  
 30 times in the two months, cannot tell where the mistake can  
 be B Dec. May have overflowed slightly



# RAINFALL AT Beckenham

*Hasgrove*

Observer.....*Percy Bicknell Esq.*

Rain { By.....

Gauge { Diameter.....*5*.....in.

Height above Ground,.....ft.....*5*.....in.

Above Mean Sea Level.....*14*<sup>P</sup>.....ft.

*5-Parent.*

YEAR.....									1868	1869	MEANS.
January.....									4.00	3.30	
February .....									1.50	3.06	
March .....									1.14	1.58	
April .....									1.82	1.26	
May .....									.79	3.12	
June .....									.35	1.28	
July .....									1.39	.62	
August .....									2.84	1.25	
September.....									1.84	3.24	
October .....									2.04	1.84	
November.....									1.26	2.53	
December .....									4.34	3.15	
TOTALS .....									23.31	26.23	

*C*



RAINFALL AT Lechladehurst

*Heathfield Lodge*

Observer *Fr. Nunes Esq M.A.*

Rain { By.....  
Gauge { Diameter.....*5*.....in.

Height above Ground, *2* ft. *1* in.

Above Mean Sea Level, *275* ft.

*5-Parent.*

YEAR.....										<i>1869</i>	MEANS.
January.....											
February .....											
March .....											
April.....											
May .....											
June.....											
July .....											
August .....											
September.....											
October .....										<i>2.46</i>	
November.....										<i>2.58</i>	
December.....										<i>2.90</i>	
TOTALS .....											

*c*



# Sidcup, Froot Gray

Miss Berens

5 in

7 in

5-Parent.

YEAR - -			1862	1863	1864	1865	1866	1867	1868	1869	MEANS.
January - -			#	2.81	.74	3.58	3.23	1.76	3.68	2.92	
February - -				.53	.98	1.87	3.92	1.14	1.37	2.40	
March - - -			8.80	.87	2.76	1.33	1.50	2.62	1.60	1.66	
April - - -				none	.66	.46	2.57	2.22	1.54	1.21	
May - - -				1.87	2.71	5.55	3.69	1.89	.57	3.90	
June - - -			6.33	3.80	1.22	1.98	3.54	1.30	.33	1.36	
July - - -				.85	.45	3.01	1.74	5.18	.58	.59	
August - -			1.45	1.20	1.74	3.57	2.13	2.34	2.47	.96	
September -				3.06	3.46	.14	4.56	1.45	2.50	3.47	
October - -			4.58	1.99	1.37	7.36	1.47	1.89	2.03	1.43	
November -			1.19	2.05	2.82	2.24	1.15	.79	1.10	2.73	
December -			2.09	1.29	.59	1.36	1.54	1.65	4.42	2.77	
TOTALS -			24.44	20.32	19.50	32.45	31.04	24.23	22.19	25.40	

c c c c c c c c c

1865 May 22 - TS 2.00 in an hour



RAINFALL AT Penge Oakfield Road

Observer... C. Mason Esq.

Kent.

Rain { By.....  
Gauge { .....  
Diameter.....in.      Height above Ground,.....ft.....in.      Above Mean Sea Level.....ft.

Kent.      5/ Thomas Parent.

YEAR.....			1862	1863						MEANS.
January.....				1.81						
February .....										
March .....										
April.....										
May .....										
June.....										
July .....										
August.....										
September.....										
October .....										
November.....										
December.....			1.54							
TOTALS .....										

C. C.



RAINFALL AT Sydenham

G. J. Chambers      Lethen Grange

Rain { By Basella

Gauge { Diameter 5 in.      Height above Ground, 1 ft. 0 in.      Above Mean Sea Level,        ft.

5-Darent.

YEAR.....							1866	1867	1868	1869	MEANS.
January .....							* 3.71				
February .....							4.71				
March .....							1.54				
April .....							2.04				
May .....							1.30				
June.....							4.49				
July .....							2.26				
August.....							3.03				
September. ...							* 3.37				
October.....							1.45				
November.....							1.78				
December.....							1.94	*			
TOTALS .....							31.62				

Day of measurement  
\* record from 22 to 30<sup>th</sup> inclusive are missing



RAINFALL AT Dartford  
The Downs

Observer Rich<sup>d</sup> & Jarvis

Rain { By Appts

Gauge { Diameter 5 in. Height above Ground 2 ft. Above Mean Sea Level 2.50 ft.

5-Darent

YEAR.....									1868	1869	MEANS.
January.....									<del>0</del> 4.02	2.26	
February .....									.99	2.19	
March .....									.73	1.56	
April .....									1.18	1.39	
May .....									.42	3.40	
June .....									.28	1.09	
July .....									.96	.32	
August .....									2.01	1.04	
September.....									2.07	3.08	
October .....									1.89	1.41	
November.....									1.15	2.72	
December .....									3.71	2.05	
TOTALS .....									19.41	22.51	

C C



Wellington, Bexley Heath  
Kent

H S H Wollaston

+ Ground 6 ft

+ Sea Level 150

5-Parent.

YEAR - -	1860	1861	1862	1863	1864	1865	1866	1867	1868	1869	MEANS.
January - -	1.60	.47	1.15	2.18	.66	3.10	2.46				
February - -	1.05	1.91	.53	.58	.96	1.78	3.83				
March - - -	1.89	2.14	3.77	.79	2.68	1.02	1.42				
April - - -	1.21	.83	3.10	.42	.70	.54	2.79				
May - - - -	3.12	2.00	2.62	1.20	2.65	4.32	1.33				
June - - - -	5.63	1.90	2.52	3.37	1.02	2.25	3.65				
July - - - -	2.53	2.24	1.86	.80	.46	3.59	2.13				
August - - -	3.25	.77	2.24	1.85	1.43	3.28	2.30				
September -	2.48	1.25	1.40	3.25	3.05	.17	4.31				
October - -	1.50	.80	4.22	2.09	1.26	7.41	1.97				
November -	2.36	4.75	1.10	1.82	2.62	1.88	1.29				
December -	2.10	1.10	1.57	1.17	.59	.79	1.75				
TOTALS -	28.72	20.16	26.08	19.52	18.08	30.13	29.23				

✓ c ✓ c ✓ c ✓ c ✓ c ✓ c



Rainfall at Croftone's Pumping Station

J. W. Bazalgette.

6w 67 8w 66  
6 3 65

11 5 66

15-67 12

Diameter of Gauge, ... 11..... in.

Height above Ground; 3... ft. 8... in.

Above Mean Sea Level, ... 10..... ft.

5- Darent

YEAR - -	1860	1861	1862	1863	1864	1865	1866	1867	1868	1869	MEANS.
January - -					# .84	2.72	2.21	2.35		2.75	
February - -					1.04	1.32	3.23	X 1.18		3.21	
March - - -					2.95	.92	1.64	2.21		1.61	
April - - -					.47	.33	2.83	1.99		1.24	
May - - -					2.57	3.62	1.91	2.03		3.67	
June - - -					.98	3.01	3.32	1.99		1.21	
July - - -					.37	3.23	1.54	5.50		.63	
August - -					1.25	3.58	2.46	+ 2.64		1.34	
September -					2.46	.27	4.09	2.02		3.40	
October - -					1.06	6.26	2.22	2.27		2.16	
November -					2.15	1.67	1.59	.61		2.77	
December -					.28	.68	2.06	1.80		3.15	
TOTALS -					16.42	27.61	29.10	25.59		27.14	

✓ c c c c c

1867<sup>x</sup> Feb Gauge broken + & again in August mean of the two other gauges taken



RAINFALL AT London No 2

Cropmets Earick  
Gardens

Rain { By .....  
Gauge { Diameter.....10.....in. Height above Ground, ..... ft. 9 in. Above Mean Sea Level, 6..... ft.

5-Parent.

YEAR .....								1867	1868	1869	MEANS.
January .....								2.25		2.42	
February .....								1.27		2.58	
March .....								2.51		1.54	
April .....								2.16		1.27	
May .....								2.27		3.73	
June .....								2.23		1.21	
July .....								5.94		.70	
August .....								2.70		1.43	
September ...								2.10		3.93	
October .....								2.36		2.36	
November ...								.60		2.79	
December .....								1.86		3.67	
TOTALS.....								28.25		27.63	

c c



RAINFALL AT London

No 3

Crossings Barith

Rain { By .....  
Gauge { Diameter.....1 1/4.....in.

Height above Ground, ..... ft. 8 in. Above Mean Sea Level, 5 ft.

24 69

5-Parent.

YEAR .....							1867	1868	1869	MEANS.
January .....							1.78		3.06	
February .....							1.08		3.03	
March .....							1.91		1.84	
April .....							1.86		1.34	
May .....							2.06		3.57	
June .....							1.89		1.20	
July .....							5.70		.61	
August .....							2.57		1.40	
September ...							1.98		4.12	
October .....							2.25		2.52	
November ...							.59		2.78	
December .....							1.79		3.53	
TOTALS.....							25.46		29.00	

c

c



*Aldwick*  
*Exp. w. Bognor*  
*Ship Npton*

8 53

12 62-4

*Die 5 + Ground 0.6 63 + Sea Level 20 feet*

YEAR - -	1860	1861	1862	1863	1864	1865	1866	1867	1868	1869	MEANS.
January - -	<sup>#</sup> 2.23	.10	1.80	2.50	1.46	3.70	4.24	2.78	3.05		
February - -	.64	1.17	.62	.42	.91	2.26	4.04	1.52	.77		
March - - -	1.02	1.71	3.81	.90	3.64	1.26	1.54	2.94	1.17		
April - - -	2.20	.58	1.46	.63	.96	.44	1.04	1.17	1.86		
May - - - -	3.13	1.61	3.32	1.45	1.37	2.39	.70	1.69	.67		
June - - - -	5.60	2.04	1.40	3.50	.72	1.60	1.95	1.48	.50		
July - - - -	2.65	2.82	1.87	.05	.23	2.48	1.61	2.48	.84		
August - - -	3.23	.48	1.70	1.95	1.04	2.73	1.56	2.32	2.76		
September -	2.36	2.77	1.55	3.56	2.51	.01	4.55	1.40	1.95		
October - -	1.96	1.29	4.67	2.85	1.92	8.65	1.39	2.65	2.85		
November -	2.24	5.23	1.15	2.27	3.31	2.45	1.40	1.26	.95		
December -	2.20	1.40	2.13	1.62	1.04	2.00	1.81	.82	5.91		
TOTALS -	29.40	21.20	25.48	21.70	19.11	29.97	25.83	22.57	23.28	23.54	24.202

*cc cc cc cc cc cc cc*



RAINFALL AT Widwick

W. Bogner

Observer..... Henry N. P. W.

Rain { By.....

Gauge { .....

Diameter.....in.

Height above Ground, 10 ft.....in.Above Mean Sea Level, 18 ft.

YEAR.....	1860	1861	1862	1863	1864	1865	1866	1867	1868	1869	MEANS.
January.....					.72	2.95	3.40	2.84			
February .....					.79	1.81	3.51	1.08			
March.....				.61	3.69	.92	1.54	2.35			
April.....				.31	.85	.29	.66	.70			
May .....				1.10	1.29	2.27	.51	1.38			
June.....				2.38	.35	1.24	1.70				
July .....				.38	.15	2.34	1.00				
August.....				1.61	.97	2.31	1.27				
September.....				3.00	2.15	.07	4.60				
October .....				2.35	1.80	8.64	1.14				
November.....				1.97	3.31	2.20	1.01				
December.....				1.44	.85	2.08	1.75				
TOTALS .....				—	16.90	27.12	22.09				

C C C C C

On Greenhouse



Worthing

Walter G. Barker

+ ground 0.0 + Sea Level 10 ft

YEAR - -	1860	1861	1862	1863	1864						MEANS.
January - -	4.66	.62									
February - -	.65	2.01									
March - - -	1.70	2.42									
April - - -	1.82	.49									
May - - - -	3.41	1.60									
June - - - -	4.98	1.97									
July - - - -	1.84	3.23									
August - - -	3.70	1.04									
September -	3.02	3.98									
October - -	2.45	1.85									
November -	2.76	7.63									
December -	3.33	2.24									
TOTALS -	34.32	29.08									

e e



RAINFALL AT *W. King (Bedford Row)*

60

*W. J. Harris*

Rain { By .....  
Gauge { .....  
Diameter.....*5*.....in.      Height above Ground, *1*... ft. *3*... in.      Above Mean Sea Level, *12*... ft.

YEAR.....							1866	1867	1868	1869	MEANS.
January .....								3.29	3.41	2.01	
February .....								1.41	1.06	2.40	
March .....								3.00	1.18	1.44	
April .....								1.32	2.14	1.06	
May .....								2.49	.89	4.29	
June.....								2.45	.64	1.38	
July .....								2.77	1.02	.18	
August.....								1.96	3.62	.97	
September ..								2.33	1.44	4.31	
October.....							<i>* 1866</i> 1.11	3.20	2.19	1.75	
November.....							1.57	1.37	1.04	2.34	
December.....							1.74	1.24	6.12	3.17	
TOTALS .....								26.83	24.75	25.30	

*c c c c*



RAINFALL AT Worthing

Bedford Row

Observer W. J. Harris

No 2

Rain { By.....

Gauge { Diameter.....8.....in.

Height above Ground,.....ft.....6.....in.

Above Mean Sea Level.....17.....ft.

YEAR.....										1869	MEANS.
January.....										# 2.11	
February .....										2.54	
March .....										1.54	
April.....										1.09	
May .....										4.28	
June.....										1.42	
July .....										.18	
August.....										1.00	
September.....										4.39	
October .....										1.79	
November.....										2.35	
December.....										3.24	
TOTALS .....										25.93	

60



RAINFALL AT Worthing  
W Works

No 3

Observer W J Harris

Rain { By .....

Gauge { Diameter 8 in.

Height above Ground, .....ft. 6 in.

Monthly

Above Mean Sea Level 25 ft.

YEAR.....									1868	1869	MEANS.
January.....											
February .....											
March .....											
April .....											
May .....									<del>#</del> .93		
June.....									.66		
July .....									1.02		
August.....									3.72		
September.....									1.68		
October .....									2.47		
November.....									.97		
December.....									7.02	#	
TOTALS .....											

More exposed than No 1 being with my other Meteorological Instruments and is the one from which I send to Regt Genl



RAINFALL AT Worthing

No 2

W Works

Observer W J Harris

Rain { By.....

Monthly

Gauge { Diameter.....5.....in.

Height above Ground.....ft.....in.

Above Mean Sea Level.....25.....ft.

YEAR.....									1868	1869	MEANS.
January.....									<del>3</del> 3.39	2.80	
February .....									1.04	2.64	
March .....									1.16	1.71	
April .....									2.40	1.17	
May .....									.98	4.27	
June.....									.39	1.47	
July .....									1.10	.14	
August.....									3.79	1.06	
September.....									1.89	4.41	
October .....									2.75	2.09	
November.....									1.05	2.45	
December.....									7.18	3.53	
TOTALS .....									27.12	27.74	

First three months was in just position with No 1 but  
a better position being obtained it was removed  
June doubtful query whether the gauge had not been tampered  
with,



RAINFALL AT *Gapton rd. Arundel,**Rich<sup>d</sup> Redford*

Rain { By .....

Gauge { Diameter.....*5*.....in.Height above Ground, *1*... ft. .... in.Above Mean Sea Level, *24*... ft.

YEAR.....							1866	1867	1868	1869	MEANS.
January .....							<i>4.48</i>	<i>3.86</i>	<i>4.31</i>	<i>3.42</i>	
February .....							<i>5.23</i>	<i>1.44</i>	<i>1.43</i>	<i>2.60</i>	
March .....							<i>2.07</i>	<i>2.73</i>	<i>1.51</i>	<i>1.73</i>	
April .....							<i>1.09</i>	<i>1.64</i>	<i>2.56</i>	<i>1.24</i>	
May .....							<i>.93</i>	<i>1.74</i>	<i>1.05</i>	<i>4.26</i>	
June.....							<i>2.69</i>	<i>2.14</i>	<i>.64</i>	<i>1.34</i>	
July .....							<i>2.52</i>	<i>3.89</i>	<i>1.26</i>	<i>.53</i>	
August.....							<i>2.51</i>	<i>2.76</i>	<i>2.62</i>	<i>1.06</i>	
September ...							<i>6.49</i>	<i>1.75</i>	<i>3.90</i>	<i>4.38</i>	
October.....							<i>1.13</i>	<i>3.23</i>	<i>2.97</i>	<i>2.69</i>	
November.....							<i>1.89</i>	<i>1.62</i>	<i>1.44</i>	<i>2.29</i>	
December.....							<i>2.17</i>	<i>1.32</i>	<i>7.57</i>	<i>3.88</i>	
TOTALS .....							<i>33.20</i>	<i>28.12</i>	<i>31.26</i>	<i>29.42</i>	

C C C C

*In kitchen garden 14 ft. from the nearest fence which is 5 ft. high several low houses & apple trees 24 to 60 yards from the gauge, the neighborhood very level & few trees or hedges, about three quarters of a mile from the sea*



West Thorney Island  
 w. Emsworth  
 A Radwick Esq<sup>r</sup> 10 in 6 2  
 1ft 64 5  
 + ground 6 in

+ S.I. 10ft 6 5

YEAR - -	1860	1861	1862	1863	1864	1865	1866	1867	1868	1869	MEANS.
January - -	2.25	.52	1.31	3.10	2.23	3.43	5.82	3.34	3.40	3.18	2.858
February - -	.78	1.98	.36	.90	.96	2.66	3.34	1.74	1.25	2.18	1.615
March - - -	1.74	2.56	4.10	1.18	3.64	.48	1.15	2.24	1.60	2.30	2.099
April - - -	1.70	.52	1.53	.67	1.74	.82	1.34	1.18	2.22	1.22	1.294
May - - - -	2.81	1.65	2.90	1.42	1.17	2.30	.92	1.27	1.02	3.63	1.909
June - - - -	6.11	2.36	1.50	3.01	1.58	1.83	1.95	1.10	.48	2.11	2.203
July - - - -	3.18	3.44	1.79	.72	.36	1.73	1.29	2.60	.82	1.52	1.745
August - - -	3.10	.72	1.34	1.91	1.29	4.84	2.38	<sup>2</sup> 1.43	4.64	.54	<sup>3</sup> 2.219
September -	3.30	3.06	1.90	4.20	3.11	.15	6.09	2.19	2.95	2.53	2.948
October - -	1.41	1.50	4.89	3.32	1.83	8.18	1.51	4.20	3.16	1.76	3.176
November -	2.72	4.36	.76	2.05	4.06	3.14	1.85	1.09	1.41	1.53	2.297
December -	4.04	1.45	2.34	1.76	.91	1.95	1.05	1.41	7.93	2.28	2.512
TOTALS -	33.14	24.12	24.72	24.24	22.88	31.51	28.69	23.79	30.88	24.78	26.875

+ 1 1 1 1 1 1 1 1 1 1 1 9

1867 - August should be 2.43, wrongly cast as 1.43  
 in Mr. Radwick's book.



# RAINFALL AT *Patching Farm*

*Sussex*

Observer *J. Hewitt Esq Jr*

Rain { By .....

Gauge { .....

Diameter.....*5*.....in.

Height above Ground,.....ft.....in.

Above Mean Sea Level.....*180*.....ft.

YEAR.....										<i>1869</i>	MEANS.
January.....											
February.....											
March.....											
April.....										<i>#</i> <i>1.19</i>	
May.....										<i>4.47</i>	
June.....										<i>1.59</i>	
July.....										<i>.24</i>	
August.....										<i>.98</i>	
September.....										<i>4.16</i>	
October.....										<i>3.56</i>	
November.....										<i>2.53</i>	
December.....										<i>4.26</i>	
TOTALS.....										<i>d</i>	

*1869 read. 11. x 11.19      E.T.H. x 1.22*

*g. read at 6.30 a.m.*



Rainfall at *Findon* *Sussex*

*Robt Cholmeley*

Diameter of Gauge, ..... in.      Height above Ground, ..... ft. *6* in.      Above Mean Sea Level, *150* ft.

YEAR - -	<i>1860</i>	<i>1861</i>	<i>1862</i>	<i>1863</i>	<i>1864</i>	<i>1865</i>	<i>1866</i>	<i>1867</i>	<i>1868</i>	<i>1869</i>	MEANS.
January - -				<i>#</i>	<i>1.41</i>	<i>5.28</i>					
February - -					<i>2.78</i>	<i>2.79</i>					
March - - -					<i>4.20</i>	<i>1.45</i>					
April - - -					<i>1.31</i>	<i>.34</i>					
May - - - -					<i>1.32</i>	<i>3.33</i>					
June - - - -					<i>1.32</i>	<i>1.40</i>					
July - - - -					<i>.65</i>	<i>2.78</i>					
August - - -					<i>1.79</i>	<i>5.24</i>					
September -					<i>4.22</i>	<i>.14</i>					
October - -					<i>1.60</i>	<i>10.51</i>					
November -					<i>4.58</i>	<i>3.33</i>					
December -					<i>1.10</i>	<i>3.24</i>					
TOTALS -					<i>26.28</i>	<i>39.83</i>					

*cc*

*1865 Oct 26 1 inch between 11 AM to 4 PM*



Chickster

Wm Hills Secy of Museum

69  
65  
64  
20/62

Sea 5m + ground 6 in

+ Sea Level 20<sup>3</sup>/<sub>4</sub>

YEAR - -	1860	1861	1862	1863	1864	1865	1866	1867	1868	1869	MEANS.
January - -	3.71	.45	2.14	3.19	1.37	4.19	6.15	3.32	3.05	2.91	3.048
February - -	95	2.01	.52	.49	1.12	2.20	4.78	1.77	1.03	1.84	1.671
March - - -	2.16	2.29	4.20	.99	4.01	1.11	1.83	3.08	1.41	1.72	2.280
April - - -	1.31	.60	1.57	.58	1.49	.55	1.10	1.55	2.25	1.06	1.206
May - - - -	3.55	1.60	3.52	1.20	1.41	2.65	.96	1.68	.91	4.31	2.179
June - - - -	5.07	1.96	1.31	3.46	1.30	2.23	1.90	1.95	.69	1.64	2.151
July - - - -	3.43	3.91	1.82	.75	.22	2.48	1.77	4.03	.81	1.09	2.031
August - - -	3.87	.47	1.45	1.07	1.39	4.39	2.31	3.21	3.57	.53	2.312
September -	4.17	3.31	1.62	4.87	3.41	.03	6.18	1.92	2.80	4.83	3.314
October - -	2.35	2.52	5.60	3.19	1.86	10.61	1.43	3.17	3.41	2.29	3.643 +
November -	3.19	4.49	1.32	1.83	4.37	3.02	1.87	1.41	1.38	1.86	2.474
December -	3.68	1.54	2.40	2.66	1.30	2.22	1.90	.96	7.30	3.21	2.717
TOTALS -	37.44	25.15	27.47	25.08	23.25	35.60	32.18	28.05	28.61	27.35	29.026

+ 2 2 2 2 2 2 2 2 2 2 2 2

1868 Dec 7.30 the greatest fall in any month since the commencement of the register in 1835

1860 - Agrees with Ans ret to G. L. Prince



## Westgate Chichester

Dr. Lycocke

Mis return

4 66

15 67

Diam. 5in. + ground bin.

+ Sea level 12ft?

YEAR - -	1860	1861	1862	1863	1864	1865	1866	1867	1868	1869	MEANS.
January - -	3.67	( <sup>2</sup> 45)	2.14	3.22	1.43	4.33	5.24	3.29	3.19	2.77	2.973
February - -	1.01	1.90	.55	.50	1.15	2.44	4.16	1.64	1.05	1.92	1.632
March - - -	2.24	2.48	4.25	1.07	3.90	1.04	1.85	2.94	1.46	1.64	2.287
April - - -	1.34	.53	1.77	.63	1.35	.50	1.04	1.41	2.02	1.02	1.169
May - - -	3.27	1.55	3.32	1.02	1.46	2.65	1.02	1.48	.76	4.21	2.074
June - - -	5.09	.86	1.31	3.47	1.32	2.04	1.79	1.77	.76	1.58	1.999
July - - -	3.56	3.73	1.85	.84	.26	2.31	1.60	3.38	.89	1.18	1.960
August - - -	4.01	.42	1.30	1.88	1.38	4.39	1.96	3.04	3.39	.69	2.246
September -	4.36	3.34	1.58	4.60	3.01	.00	6.26	1.78	2.62	5.05	3.268
October - -	2.34	2.54	4.03	3.17	1.80	10.06	1.40	3.22	3.21	1.93	3.370
November -	2.94	4.69	1.21	2.16	4.37	2.98	1.82	1.29	1.37	1.75	2.458
December -	3.83	1.43	2.40	2.66	1.28	2.51	1.94	.98	7.03	3.17	2.723
TOTALS -	37.66	(23.92)	25.71	25.22	22.71	35.41	30.08	26.22	27.75	26.91	28.159

Record for Jan. 1861 lost.



Shropwyke

w. Chichester

Rev<sup>d</sup> G. H. Woods

14 in 67

14 in

8 in + ground 1.3

+ Sea level 61 ft

YEAR - -	1860	1861	1862	1863	1864	1865	1866	1867	1868	1869	MEANS.
January - -	3.58	.53	2.12	3.00	1.16	3.71	5.55	3.29	3.89	3.10	2.993
February - -	.91	1.75	.57	.45	1.00	1.91	4.51	1.76	1.20	2.24	1.630
March - - -	2.01	2.29	4.24	.80	3.74	1.17	2.06	2.85	1.52	1.85	2.253
April - - - -	1.15	.51	1.46	.73	1.33	.50	1.08	1.56	2.18	1.28	1.178
May - - - -	3.85	1.25	3.20	1.79	1.23	2.90	1.03	1.69	1.09	4.30	2.233
June - - - -	5.00	1.49	1.50	3.45	1.10	2.01	1.94	1.87	.76	1.58	2.070
July - - - -	2.90	3.98	1.93	.70	.70	2.87	1.82	4.20	.97	.91	2.104
August - - -	4.21	.66	1.25	1.62	1.33	3.75	2.50	2.98	3.67	.81	2.278
September -	3.75	3.27	1.35	4.11	3.54	.05	6.51	1.54	3.12	5.28	3.252
October - -	2.40	2.03	5.90	2.70	1.56	10.78	1.40	3.52	3.48	2.34	3.611
November -	3.54	4.43	1.26	2.05	3.60	3.88	2.02	1.45	1.52	2.07	2.582
December -	4.21	1.59	2.37	2.35	1.20	3.17	2.32	1.22	7.93	3.74	3.010
TOTALS -	37.51	23.78	27.15	23.75	21.55	36.70	32.74	27.93	31.33	29.50	29.194













Funtington  
w<sup>th</sup> Chichester  
by Mr Fort Esq<sup>r</sup> - Woods

60

+ Ground 14<sup>ft</sup> + Sea level 70<sup>ft</sup>

YEAR - -	1860	1861	1862	1863	1864	1865	1866	1867	1868	1869	MEANS.
January - -	3.00	2.47	2.46	3.63	}						
February - -	.00		.51	.76							
March - - -	1.50	2.01	4.78	1.12							
April - - -	1.48	1.26	.98	.57							
May - - - -	3.47	1.42	4.64	1.87							
June - - - -	6.14	1.58		3.29							
July - - - -	1.50	4.06		1.06							
August - - -	4.74	.34	4.01	2.47							
September -	3.19	2.00		4.07							
October - -	3.39	6.10	6.41	3.29							
November -	3.34			2.68							
December -	2.95	1.04	2.97	2.69							
TOTALS -	35.50	22.28	26.76	27.50							

cc cc cc



Slindon  
Rectory  
Rev M A Smelt

Glaisher's J. + Ground 1 ft? + Sea Level 200? <sup>1856</sup>

YEAR - -	1860	1861	1862	1863	1864	1865	1866	1867	1868	1869	MEANS.
January - -	4.11	2.59	2.41	3.62							
February - -	1.22	2.18	.71	.70							
March - - -	2.80	2.86	4.52	1.42							
April - - -	1.50	.85	1.84	.90							
May - - - -	3.97	1.37	3.91	2.26							
June - - - -	6.14	2.30	1.67	4.22							
July - - - -	3.00	3.75	2.56	.74							
August - - -	5.00	.79	1.74	2.19							
September -	4.73	4.03	2.10	4.33							
October - -	2.84	2.30	6.40	4.30							
November -	3.30	5.30	1.33	2.68							
December -	5.45	1.86	2.88	3.60							
TOTALS -	44.06	28.18	32.07	31.16							



Dale Park

Arundel

J. E. Fletcher

3166 69

4 ft 64 5

Di. 11

+ Ground 0.0

+ Sea Level 316 ft

YEAR - -	1860	1861	1862	1863	1864	1865	1866	1867	1868	1869	MEANS.
January - -	4.59	.31	2.09	3.70	2.11	4.29	8.28	2.61	4.23	3.22	3.543
February - -	.80	.29	.56	.28	.41	3.36	5.44	2.77	1.28	3.27	1.846
March - - -	2.90	2.86	4.56	1.51	3.43	1.45	1.20	3.54	1.88	1.35	2.468
April - - - -	1.71	.94	1.64	.90	1.02	.28	1.71	1.93	2.11	1.13	1.337
May - - - - -	4.52	1.82	3.90	2.94	1.31	2.72	1.08	2.14	1.21	4.75	2.639
June - - - - -	6.65	2.89	2.02	4.17	.82	1.74	2.95	2.28	.86	1.52	2.590
July - - - - -	3.23	3.62	2.24	1.45	.05	3.73	2.12	5.67	1.04	.80	2.395
August - - -	6.46	1.27	2.12	2.01	1.33	5.28	2.77	3.20	3.87	1.05	2.936
September -	5.09	2.20	1.68	5.25	3.70	.12	8.15	2.01	3.94	5.35	3.749
October - - -	3.32	2.02	0.94	4.05	1.63	12.23	1.52	3.54	4.06	4.11	4.542
November -	3.89	3.96	1.28	1.88	3.61	3.86	2.70	1.90	1.43	.84	2.535
December -	1.93	1.93	2.99	2.81	1.29	3.20	3.20	2.06	8.86	3.25	3.152
TOTALS -	45.09	24.11	34.02	30.95	20.71	42.26	41.12	33.65	34.77	30.64	33.732

✓ 1864 + Ground 4 ft.  
 ✓ 1865 + Ground 4 ft.  
 ✓ 1866 + Ground 4 ft.  
 ✓ 1867 + Ground 4 ft.  
 ✓ 1868 + Ground 4 ft.  
 ✓ 1869 + Ground 4 ft.



RAINFALL AT *Steyning**Hugh Ingram**Supper*

Rain { By.....

Gauge { Diameter.....*5*.....in.Height above Ground, *1*... ft. *2*... in.Above Mean Sea Level, *80*? ft.

YEAR.....							1866	1867	1868	1869	MEANS.
January .....							<i>6.20</i>		<i>5.25</i>	<i>3.95</i>	
February .....							<i>6.17</i>		<i>3.11</i>	<i>3.71</i>	
March .....							<i>2.09</i>			<i>2.11</i>	
April .....							<i>1.92</i>		<i>3.02</i>	<i>1.45</i>	
May .....							<i>1.85</i>		<i>1.01</i>	<i>5.03</i>	
June .....							<i>3.81</i>		<i>1.76</i>	<i>1.68</i>	
July .....							<i>1.89</i>		<i>2.16</i>	<i>.36</i>	
August .....							<i>3.07</i>		<i>4.16</i>	<i>1.26</i>	
September ...							<i>7.40</i>		<i>2.48</i>	<i>5.34</i>	
October .....							<i>2.00</i>		<i>3.58</i>	<i>3.03</i>	
November .....							<i>2.70</i>		<i>1.36</i>	<i>3.86</i>	
December .....							<i>4.35</i>		<i>9.36</i>	<i>5.24</i>	
TOTALS .....							<i>43.45</i>		<i>36.25</i>	<i>37.02</i>	

*1868 includes from 24<sup>th</sup> Dec<sup>r</sup> to 1<sup>st</sup> of Jan<sup>y</sup> in first entry*

*I have moved the gauge as recommended by you*



Westdean

nr Chichester

H Paston Esq<sup>r</sup>14 69  
1.4 65

N 8 in + Ground 6 in

+ Sea Level 250 ft

YEAR - -	1860	1861	1862	1863	1864	1865	1866	1867	1868	1869	MEANS.
January - -	4.52	.75	3.01	4.33	2.31	4.64	6.72	4.04	4.35	4.42	3.909
February - -	1.37	2.56	.66	1.03	1.79	3.01	5.40	2.34	1.54	3.19	2.289
March - - -	3.03	3.25	5.93	1.49	4.28	1.50	2.14	3.18	1.96	2.18	2.894
April - - -	2.04	.79	2.13	.76	1.44	.66	1.79	2.22	2.46	1.28	1.577
May - - -	4.53	1.79	3.67	2.47	1.57	3.26	1.72	1.42	1.29	5.12	2.684
June - - -	7.06	2.45	1.66	4.20	1.66	2.61	2.99	2.08	1.02	2.10	2.783
July - - -	2.98	4.45	2.36	.85	.46	2.79	1.76	4.95	1.17	1.31	2.308
August - -	5.68	1.18	3.14	2.31	1.35	5.69	3.32	3.77	4.69	1.34	3.247
September -	5.15	3.94	2.07	5.49	4.46	.30	7.75	2.44	2.96	7.03	4.159
October - -	3.35	2.45	6.68	4.81	2.23	12.45	1.59	3.56	4.51	2.30	4.393
November -	4.07	5.12	1.54	2.82	4.43	4.41	2.32	1.68	1.73	2.65	3.077
December -	5.16	2.06	3.26	3.57	1.50	3.35	3.20	1.20	9.75	4.57	3.762
TOTALS -	48.94	30.79	36.11	34.13	27.48	44.67	40.70	32.88	37.63	37.49	37.082

C C C C C C C C C C

4.20 ft



Chilgrove  
Chichester

Weyland Woods Esq<sup>r</sup>

266 030'68

Knight's 5 in + ground 6 in? + Sea Level 284 feet 62

YEAR - -	1860	1861	1862	1863	1864	1865	1866	1867	1868	1869	MEANS.
January - -	4.34	.70	3.21	3.95	2.06	4.35	4.70	3.65	4.34	3.51	3.497
February - -	1.56	2.00	.75	.94	1.48	2.60	4.49	2.66	1.53	2.91	2.094
March - - -	2.10	2.96	3.99	1.21	3.39	1.26	1.79	2.05	2.06	1.80	2.269
April - - -	1.75	.76	1.13	.57	1.48	.43	1.58	2.06	2.61	1.10	1.347 -
May - - - -	3.85	1.55	3.55	2.35	1.60	2.89	1.43	1.40	1.20	4.42	2.424
June - - - -	6.72	2.34	2.60	4.52	1.33	2.27	2.94	1.85	.61	1.95	2.713
July - - - -	2.88	4.81	2.74	.09	.38	2.44	1.99	4.76	.93	1.15	2.297
August - - -	5.05	.73	2.39	1.99	1.04	5.49	3.24	3.41	4.81	1.55	2.970
September -	3.86	3.94	2.24	4.20	4.26	.30	8.08	2.24	3.43	6.00	3.855 +
October - - -	2.86	1.81	5.17	4.33	1.88	9.95	1.50	2.82	4.01	2.31	3.664
November - -	3.60	4.99	1.45	2.24	4.35	3.50	2.10	1.03	1.64	2.47	2.737
December - -	3.41	1.92	3.13	3.26	1.42	2.97	2.74	1.55	0.96	4.21	3.357
TOTALS -	42.00	28.67	32.35	30.45	24.67	38.45	36.66	29.48	36.13	33.38	33.224

+ 0 0 0 0 0 0 0 0 0 0 0

1860 If snow included should be 1.50 more = 43.50

1863 October is again nearly the wettest month in the year, for a series of years October has been the wettest month & July the most dry one

1864 Aug 23<sup>d</sup> the first good rain for 60 days



Rainfall at *Bepton Hill**W. Leyland Woods.*Diameter of Gauge, ...*5*..... in.Height above Ground, ..... ft. *6*... in.Above Mean Sea Level, *554*.. ft.

YEAR - -	1860	1861	1862	1863	1864	1865	1866	1867	1868	1869	MEANS.
January - -					<sup>4</sup> 2.30	4.71	5.21	4.66	5.72	4.70	
February - -					1.75	3.20	5.94	3.02	2.00	1.73	
March - - -					3.82	1.24	1.79	3.12	2.55	3.72	
April - - -					1.78	.53	2.15	2.40	3.35	1.30	
May - - - -					1.71	3.27	1.53	1.50	1.59	5.21	
June - - - -					1.79	2.55	3.12	1.72	.93	2.34	
July - - - -					.63	2.49	2.27	5.95	1.29	1.50	
August - - -					1.23	6.26	3.37	3.52	5.56	1.54	
September -					4.08	.40	7.71	2.25	3.60	6.15	
October - -					2.38	10.37	1.50	3.84	4.20	2.15	
November -					4.51	5.25	2.57	1.58	1.93	2.90	
December -					1.54	3.61	3.87	1.48	10.17	5.61	
TOTALS -					27.52	43.80	41.03	35.04	42.97	38.85	

1864 The *g* stands almost on the top of the range of the south downs, 2 miles NE of Chilgrove & 200 ft below the highest portion



Petworth Rectory  
Sussex

New to Holland

2 ft 65 69  
6

190 69

5 in + ground 4 in

+ Sea Level 170

YEAR - -	1860	1861	1862	1863	1864	1865	1866	1867	1868	1869	MEANS.
January - -			# 2.75	3.30	1.55	4.95	5.55	4.11	4.92	4.13	
February - -			.25	1.90	1.40	2.34	5.54	2.39	1.74	3.50	
March - - -			4.45	1.35	2.84	1.23	2.44	3.20	1.91	1.43	
April - - -			1.90	.40	1.50	.22	1.81	2.61	3.08	1.24	
May - - -			3.70	1.40	1.88	3.36	1.06	2.05	.98	4.91	
June - - -			2.13	4.16	1.40	1.10	2.84	2.07	.41	1.78	
July - - -			1.51	.70	.33	2.46	1.94	5.27	1.64	.77	
August - -			2.23	1.35	1.36	5.02	2.34	2.40	4.22	.99	
September -			1.99	4.30	3.31	.16	6.91	2.05	4.44	5.61	
October - -			7.30	4.35	1.50	10.19	.94	3.59	3.31	2.06	
November -				2.10	4.67	4.43	1.75	1.27	1.72	2.14	
December -			1.10	1.20	1.28	3.37	2.45	1.10	9.00	4.55	
TOTALS -			29.31	26.57	23.02	38.83	35.57	32.11	37.37	33.11	

e e e e e e e e











37 Fair Oak  
Hon. W. B. C. 4 m E of P  
Woods

+ ground bin

+ Sea level 245 ft

YEAR - -	1860	1861	1862	1863	1864	1865	1866	1867	1868	1869	MEANS.
January - -	4.65	2.16	2.35	4.79	}						
February - -	1.60		.97	.95							
March - - -	1.85	5.23	4.99	1.00	}						
April - - -	2.17		2.28	.88							
May - - - -	1.62	2.13	.54		}						
June - - - -	9.46	1.17	4.80	5.83							
July - - - -	2.80	4.54	2.53		}						
August - - -	4.94		2.10	2.12							
September -	7.10	6.63	1.50	6.42							
October - -			6.78	2.8							
November -	3.21	2.59	1.20	3.40							
December -	5.18	4.12	4.87	3.70							
TOTALS -	44.58	28.57	34.91	31.17							

✓ ✓ ✓ ✓



RAINFALL AT Horsham

St. Leonards Lodge n. Leonard's Lee.  
Mr. S. Lord. (gardener)

Rain { By .....  
Gauge { Diameter.....6.....in.

57° N  
0. 2 1/2 W

Height above Ground, 1... ft. 6... in. Above Mean Sea Level, 300... ft.

YEAR.....							1866	1867	1868	1869	MEANS.
January .....							4.94	3.54	4.13		
February .....							4.00	1.51	1.17		
March .....							2.02	2.40	1.40		
April .....							1.45	2.28	1.00		
May .....							1.01	1.50	.80		
June.....						# 1/18	2.76	2.38	2.06		
July .....						2 5/8	1.36	4.96	1.86		
August .....						4.41	1.61	2.13	3.97		
September ...						.21	8.26	2.25	2.50		
October.....						8.10	1.60	4.71	2.44		
November.....						3.02	1.70	.94	3.60		
December.....						2.50	2.38	1.07	7.50		
TOTALS .....							33.09	29.67	30.43		

e c c c



Rainfall at Lynch Lophosk  
Midhurst

J Ennes

Diameter of Gauge, 5 in.

Height above Ground, ..... ft. 6 in.

Above Mean Sea Level, 160 ft.

YEAR - -							1866	1867	1868	1869	MEANS.
January - -							<sup>#</sup> 6.64	4.24	5.63	4.84	
February - -							6.48	2.92	1.79	3.61	
March - - -							2.19	3.44	2.20	1.97	
April - - -							2.17	2.54	3.40	1.22	
May - - - -							1.57	1.41	1.54	5.63	
June - - - -							3.28	1.95	.82	1.62	
July - - - -							2.31	5.50	1.13	1.40	
August - - -							3.21	3.17	4.87	1.31	
September -							8.58	2.38	5.48	6.60	
October - -							1.57	3.54	4.10	1.79	
November -							2.37	1.50	1.93	2.71	
December -							3.54	1.23	10.30	5.27	
TOTALS -							43.85	33.82	43.19	37.97	

C C C C

North East Side of the South Downs.

9 on grass about 200 yds N of one of the highest points of the South down hills

1868 Sept 26th 2.10 in in night.



RAINFALL AT *Haslemere Hawksfold*

*Jernhurst*

*Eliza Anne Salvin*

Rain { By *92.63* .....

Gauge { Diameter.....*0* .....in.

Height above Ground, ..... ft. *10*.. in.

Above Mean Sea Level, *330*<sup>1</sup> ft.

YEAR .....	<i>1860</i>	<i>1861</i>	<i>1862</i>	<i>1863</i>	<i>1864</i>	<i>1865</i>	<i>1866</i>	<i>1867</i>	<i>1868</i>	<i>1869</i>	MEANS.
January .....						} <i>5.67</i>	<i>5.04</i>	<i>3.77</i>	<i>6.10</i>	<i>4.17</i>	
February .....							<i>4.59</i>	<i>2.56</i>	<i>1.27</i>	<i>3.43</i>	
March .....							<i>.86</i>	<i>2.93</i>	<i>2.89</i>	<i>1.45</i>	<i>.93</i>
April .....						<i>.24</i>	<i>1.89</i>	<i>2.25</i>	<i>2.53</i>	<i>.90</i>	
May .....						<i>2.40</i>	<i>1.51</i>	<i>1.25</i>	<i>1.05</i>	<i>5.53</i>	
June .....						<i>2.39</i>	<i>2.48</i>	<i>1.55</i>	<i>.51</i>	<i>1.19</i>	
July .....						<i>1.19</i>	<i>1.60</i>	<i>4.63</i>	<i>1.60</i>	<i>1.13</i>	
August .....						<i>#1.02</i>	<i>6.69</i>	<i>2.53</i>	<i>3.01</i>	<i>5.19</i>	<i>1.22</i>
September ...						<i>2.85</i>	<i>.17</i>	<i>4.98</i>	<i>1.82</i>	<i>3.63</i>	<i>6.02</i>
October .....						<i>2.10</i>	<i>0.61</i>	<i>1.24</i>	<i>2.91</i>	<i>2.94</i>	<i>2.07</i>
November ...						<i>3.09</i>	<i>3.40</i>	<i>1.90</i>	<i>.81</i>	<i>1.75</i>	<i>1.60</i>
December .....						<i>1.89</i>	<i>3.61</i>	<i>2.70</i>	<i>1.32</i>	<i>6.72</i>	<i>3.90</i>
TOTALS .....						<i>35.23</i>	<i>33.39</i>	<i>28.77</i>	<i>34.90</i>	<i>32.09</i>	

*c c c c c c*



RAINFALL AT *Milledale House*

*J M Heath*

[ *Liphook* ]

Rain { By .....  
Gauge { .....  
Diameter.....*1.0*.....in.

Height above Ground, *25*. ft. .... in.

Above Mean Sea Level, *322*. ft.

YEAR.....							1866	1867	1868	1869	MEANS.
January .....							<i>5.11</i>	<i>3.94</i>	<i>5.20</i>	<i>4.12</i>	
February .....							<i>4.77</i>	<i>2.55</i>	<i>1.43</i>	<i>3.34</i>	
March .....							<i>2.41</i>	<i>3.29</i>	<i>1.79</i>	<i>2.08</i>	
April .....							<i>2.41</i>	<i>2.05</i>	<i>2.90</i>	<i>1.09</i>	
May .....							<i>1.38</i>	<i>1.35</i>	<i>1.32</i>	<i>5.58</i>	
June.....							<i>2.48</i>	<i>2.15</i>	<i>.60</i>	<i>1.82</i>	
July .....							<i>2.27</i>	<i>4.39</i>	<i>1.12</i>	<i>1.56</i>	
August.....							<i>3.01</i>	<i>3.08</i>	<i>5.90</i>	<i>1.38</i>	
September ...							<i>4.17</i>	<i>3.05</i>	<i>4.07</i>	<i>5.05</i>	
October.....							<i>3.84</i>	<i>3.54</i>	<i>3.29</i>	<i>2.29</i>	
November.....								<i>.91</i>	<i>1.45</i>	<i>2.14</i>	
December.....							<i>2.63</i>	<i>1.29</i>	<i>7.89</i>	<i>4.48</i>	
TOTALS .....							<i>34.48</i>	<i>31.59</i>	<i>36.96</i>	<i>34.93</i>	

*C C C C*



# RAINFALL AT Shillingtree Park

Observer.....

Rain { By.....

Gauge { .....

Diameter.....in.

Height above Ground,.....ft.....in.

Above Mean Sea Level.....ft.

YEAR.....	1860	1861	1862	1863	1864	1865	1866	1867	1868	1869	MEANS.
January.....								3.15	4.71	4.68	
February .....								2.00	1.41	3.61	
March .....								2.59	1.48	1.33	
April.....								2.55	2.63	1.17	
May .....								1.32	.85	4.71	
June.....								1.18	.40	1.11	
July .....								4.30	3.06	.53	
August.....								2.90	4.36	1.11	
September.....								1.62	2.45	4.16	
October .....								2.71	2.79	2.72	
November.....								.91	1.74	2.10	
December.....								1.03	8.42	3.93	
TOTALS .....								26.26	34.30	31.16	

C C C



RAINFALL AT Beachy Head

Mrs W L Hall

Monthly

Rain { By .....  
Gauge { Diameter.....5.....in.

Height above Ground, 1 ft. 6 in.

Above Mean Sea Level, 610 ft.

YEAR .....								1867	1868	1869	MEANS.
January .....									3.20	2.45	
February .....									.66	2.90	
March .....								<del>#</del> 2.30	1.40	—	
April .....								1.38	1.50	—	
May .....								2.37	1.01	—	
June .....								.65	.63	1.50	
July .....								2.84	.30	.36	
August .....								2.94	3.20	1.03	
September ...								.81	.52	3.80	
October .....								3.60	3.24	2.03	
November ...								1.75	1.28	2.09	
December .....								.80	4.57	3.47	
TOTALS .....									21.51		

c c c

1868 One days rain in Sep? lost from the gauge having been blown over



# RAINFALL AT Eastbourne

60

*Supix*

*Wilhelmina L Hall*

Rain { By .....  
Gauge { Diameter.....*5*.....in.

Height above Ground, *4* ft. *3* in.

Above Mean Sea Level, *12* ft.

YEAR .....								1867	1868	1869	MEANS.
January .....								<i>4.11</i>	<i>4.77</i>	<i>3.24</i>	
February .....								<i>2.32</i>	<i>.73</i>	<i>2.92</i>	
March .....								<i>3.84</i>	<i>1.95</i>	<i>1.93</i>	
April .....								<i>1.65</i>	<i>1.78</i>	<i>1.31</i>	
May .....								<i>2.49</i>	<i>1.07</i>	<i>3.48</i>	
June .....								<i>.76</i>	<i>.85</i>	<i>.75</i>	
July .....								<i>3.39</i>	<i>1.26</i>	<i>.32</i>	
August .....								<i>2.01</i>	<i>5.28</i>	<i>1.31</i>	
September ...								<i>1.26</i>	<i>.85</i>	<i>3.16</i>	
October .....								<i>3.99</i>	<i>3.61</i>	<i>2.42</i>	
November ...								<i>1.08</i>	<i>1.39</i>	<i>2.47</i>	
December .....								<i>3.07</i>	<i>6.82</i>	<i>3.37</i>	
TOTALS .....								<i>29.97</i>	<i>30.36</i>	<i>26.68</i>	

*c c c*



RAINFALL AT Eastbourne

*Mr W L Hall*

*The Gore*

Observer.....

Rain { By.....  
Gauge { Diameter.....*5*.....in.

Height above Ground,.....*1*.....ft.....in.

Above Mean Sea Level.....*8*.....ft.

YEAR.....							1866	1867	1868	1869	MEANS.
January.....								3.22	3.49		
February .....								2.15	.55		
March .....								3.35	1.58		
April.....								1.48	1.59		
May .....						<i>4</i>	.40	2.71	1.06		
June.....							2.69	.78	.80		
July .....							1.73	3.41	1.30		
August.....							3.41	2.20	5.80		
September.....							5.70	1.20	.73		
October .....							1.88	3.34	3.12		
November.....							1.68	.83	<i>lost</i>		
December.....							2.21	2.30	6.50		
TOTALS .....								26.97			

*e . c c*

*This G is placed in the middle of a large lawn two miles distant from the sea 12 ft above sea and in a well sheltered position*



Rainfall at *Pevensey*

W. Major Ridler

from 1863 } Diameter of Gauge, ..... 8 in.  
Negretti's

Height above Ground, ..... 4 ft. .... in.

Above Mean Sea Level, ..... 10 ft.

350 ft from Sea.

YEAR - -	1860	1861	1862	1863	1864	1865	1866	1867	1868	1869	MEANS.
January - -						3.91	3.50	2.86	2.88	2.72	
February - -						1.91	2.82	1.43	.68	1.89	
March - - -	4.92	2.48	5.71	4.35	3.72	1.17	1.72	2.56	1.03	1.27	
April - - -						.12	1.17	1.16	1.40	1.11	
May - - - -						3.52	.55	2.24	.87	3.87	
June - - - -	8.56	5.94	6.07	5.00	3.47	.97	1.63	.73	.79	.63	
July - - - -						2.08	1.67	3.17	1.34	.34	
August - - -						2.35	2.29	1.31	3.05	1.26	
September -	9.47	5.79	4.71	5.45	4.25	0.00	4.27	1.08	.94	3.35	
October - - -						9.34	1.32	3.31	2.10	1.67	
November - -						2.19	1.37	1.20	1.17	1.79	
December - -	6.68	9.21	6.57	4.96	7.37	1.70	1.34	1.65	5.72	2.66	
TOTALS - -	29.63	23.42	23.06	19.84	18.81	29.26	23.66	22.70	22.57	22.56	23.565

1860 to 1862. Gauge by Jones of Holborn 12 in diam. 2 ft below M.S.L.

On the beach

The rainfall here is small because the clouds are drawn right and left by Beachy Head and Fairlight - Most of the r. which waters the Weald of Sussex passes through the gap in the downs near Wilmington, and heavy rain often falls at Hailsham when there is none on the coast



RAINFALL AT *Penrimesey Vicarage*  
*Sussex*

Observer *Rev<sup>d</sup> H. Browne*

Rain { By.....

Gauge { Diameter.....in. Height above Ground, *5* ft.....in. Above Mean Sea Level *20?* ft.

YEAR.....	1861	1862	1863	1864	1865	1866	1867				MEANS.
January.....		2.02	3.43	<del>1.95</del>	5.23	4.53	4.21				
February.....		.82	<del>1.91</del>	1.73	2.74	3.70	1.86				
March.....		4.12	.96	<del>2.87</del>	1.74	2.12	2.79				
April.....		1.14	.44	.96	.24	1.17	1.51				
May.....		3.18	2.18	1.85	3.76	.68	2.20				
June.....		2.14	<del>3.17</del>	1.51	1.10	1.65	.79				
July.....	<i>1.67</i>	<i>1.47</i>	.71	.39	1.75	1.71	3.19				
August.....	1.09	1.60	1.70	1.99	3.22	2.75	1.37				
September.....	3.67	2.52	3.93	2.04	.00	5.68	1.36				
October.....	<del>2.52</del>	6.79	2.89	1.87	10.58	1.53	3.55				
November.....	<del>8.91</del>	.80	<del>2.56</del>	6.44	2.51	2.08	.60				
December.....	<del>1.71</del>	2.76	<del>2.65</del>	.82	2.14	2.72	<del>2.44</del>				
TOTALS.....		20.36	<del>25.31</del>	23.32	<del>35.01</del>	30.32	<del>24.90</del>				

*G on lawn 30 ft N of the house partly sheltered by a young growing tree*

*Corrections made by Rev<sup>d</sup> H. Browne*







RAINFALL AT Brighton Clifton Terrace

Observer J. A. Hingston

Rain { By.....  
Gauge { .....  
Diameter.....in.      Height above Ground,.....ft.....in.      Above Mean Sea Level.....ft.

YEAR.....	1860									MEANS.
January.....	3.71									
February .....	.84									
March .....	2.13									
April.....	1.46									
May .....	3.17									
June.....	4.76									
July .....	2.57									
August.....	3.17									
September.....										
October .....										
November.....										
December .....										
TOTALS .....										

C



Brighton

Dr Kebbell

3/6 65

40 ft 65

+ Ground 4 ft

+ Sea Level 50 ft?

YEAR - -	1860	1861	1862	1863	1864	1865	1866	1867	1868	1869	MEANS.
January - -	4.32	.38	1.90	3.04	1.30	4.50	3.99	3.63			
February - -	1.00	1.75	.70	.08	1.50	2.03	4.40	2.14			
March - - -	1.65		5.10	1.00	3.60	1.43	2.00	3.00			
April - - - -	2.00	.50	1.30	.07	.60	.54	1.11	1.60			
May - - - - -	3.42	1.43	2.80	1.06	1.30	3.48	.70	2.26	#		
June - - - - -	5.15	1.90	2.00	3.04	.60	.65	2.17				
July - - - - -	2.65	3.45	1.90	.06	.60	2.44	2.24				
August - - -	3.45	1.05	1.00	2.08	2.20	3.63	2.24				
September -	2.50	4.15	2.10	4.05	3.90	.35	5.73				
October - - -	2.34	2.10	7.10	4.00	1.70	10.10	1.90				
November - -	2.60	6.90	.90	1.05	4.40	2.48	1.97				
December - -	3.00	1.55	2.00	3.08	1.15	2.70	2.80	*			
TOTALS -	34.08		28.80	28.10	22.85	35.13	31.23				

C C C C C C C

1864 for the fall in D.S. I am indebted to  
J H Wingaster Esq



Rainfall at Brighton

Diameter of Gauge, ..... in.      Height above Ground, ..... ft. .... in.      Above Mean Sea Level, ..... ft.

YEAR - -	1860										MEANS.
January - -	1.50										
February- -	.56										
March - - -	1.00										
April- - - -	.81										
May - - - -	3.25										
June- - - -	5.50										
July - - - -	2.94										
August- - -	3.44										
September -	2.94										
October - -	2.25										
November -	2.81										
December -	2.37										
TOTALS -	29.37										

0 Newspaper



RAINFALL AT Hove n<sup>r</sup> Brighton39 Cambridge RoadObserver.....H. W. Peake.....Rain { By.....Leasdales.....Gauge { Diameter.....5.25.....in.Height above Ground.....1.....ft.....in.Above Mean Sea Level.....120.....ft.

YEAR.....	1860	1861	1862	1863	1864	1865	1866	1867	1868	1869	MEANS.
January.....				2.38	1.15	4.36	3.80	2.92	3.63	2.64	
February.....				.90	1.39	2.35	3.76	2.05	.93	2.55	
March.....				1.01	3.36	1.22	1.66	2.50	1.26	1.87	
April.....				.67	.74	.46	1.21	1.50	2.30	1.28	
May.....				1.95	1.37	3.33	.67	2.39	1.51	4.18	
June.....				3.62	.96	.73	1.95	1.44	.77	1.19	
July.....				1.44		2.36	1.87	3.00	1.10	.16	
August.....			.52		1.83	3.42			3.37	1.48	
September.....			2.68		3.36	.30	7.63	3.83	2.23	3.90	
October.....			4.19	3.09	1.40	8.66	1.70	3.06	2.87	1.85	
November.....			.90	1.67	4.12	2.55	2.03	1.86	1.28	2.50	
December.....			2.71	2.50	.24	2.53	2.20	1.53	6.75	3.13	
TOTALS.....						32.26			28.08	26.73	

Between houses consequently too sheltered particularly when rain from SW or SE winds higher  
 Two gauges one emptied after the fall the other at the end of the month, Both stand within 2 feet of each other and at the same height



RAINFALL AT Brighton  
55 Buckingham Place

Observer Fredt. Ernst Sawyer

Rain { By Howard's

Gauge { Diameter 5 in. Height above Ground 8 ft. in. Above Mean Sea Level 19.8 ft.

YEAR.....										1869	MEANS.
January.....										2.42	
February .....										2.63	
March .....										1.90	
April.....										1.25	
May .....										4.13	
June.....										1.19	
July .....										.08	
August .....										1.56	
September.....										3.82	
October .....										2.02	
November.....										2.69	
December.....										3.06	
TOTALS .....										26.75	

Ground plan showing the position of gauge

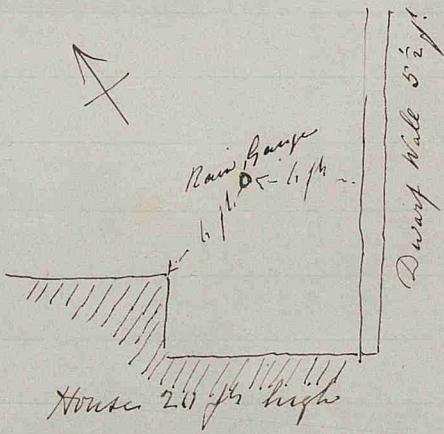



RAINFALL AT *Kemp Town Brighton*  
*Caton Place*

Rain { By *J. Barker*  
Gauge { Diameter *8* in. Height above Ground, *0* ft. *0* in. Above Mean Sea Level, *100* ft.

*2 68*

YEAR.....							1866	1867	1868	1869	MEANS.
January .....								3.18	3.86	2.81	
February .....								1.94	67	2.67	
March .....							1.82	3.03	1.74	1.48	
April .....							1.07	1.60	2.44	1.21	
May .....							.73	2.13	1.79	3.27	
June .....							2.29	1.40	.74	1.06	
July .....							2.60	3.35	.96	.13	
August .....							2.31	1.75	3.36	1.30	
September ..							5.21	2.25	1.63	2.95	
October .....							1.64	3.47	3.47	2.62	
November .....							1.83	.73	1.19	2.62	
December .....							2.38	2.54	6.57	3.33	
TOTALS .....								27.37	28.42	25.45	

*c c c c*







RAINFALL AT Brighton

S R Legg

B W W Comp

Rain { By Basella  
Gauge { Diameter 5 in.

Height above Ground, 1 ft. .... in.

Above Mean Sea Level, 7.0 ft.

YEAR.....							1866	1867	1868	1869	MEANS.
January .....							4.30	3.01	3.53	2.74	
February .....							4.49	2.13	2.42	2.83	
March .....							2.07	3.21	1.32	2.25	
April .....							1.77	1.30	2.46	1.31	
May .....							.70	2.43	1.67	4.34	
June.....							2.32	1.47	.76	1.30	
July .....							2.57	3.61	1.71	.16	
August.....							2.23	2.12	3.74	1.70	
September ...							6.09	2.34	.85	3.79	
October.....							2.11	3.12	4.53	2.90	
November.....							2.24	1.35	1.24	2.61	
December.....							2.79	3.29	7.55	3.81	
TOTALS .....							33.68	29.38	31.78	29.74	

C C C C



RAINFALL AT *Morganton*

*St James Street*

Observer *E. Pringley Esq.*

Rain { By.....  
Gauge { .....

Diameter.....in.      Height above Ground,.....ft.....in.      Above Mean Sea Level.....ft.

YEAR.....							1866	1867	1868	1869	MEANS.
January.....								4.29	4.09	2.85	
February .....								1.61	1.08	2.95	
March .....								2.85	1.03	1.83	
April.....								1.57	2.59	1.40	
May .....								2.35	1.14	4.51	
June.....								1.43	.87	1.23	
July .....								3.54	1.41	.09	
August.....								2.23	3.18	1.26	
September.....							# 5.35	2.26	2.57	4.19	
October .....							1.80	3.47	3.48	2.26	
November.....							2.01	2.39	.92	2.65	
December .....							2.25	1.79	7.46	3.56	
TOTALS .....								29.72	29.82	28.78	

c   c   c   c



Hastings  
39 Town

J. L. Savory Esq.

+ Ground 00

+ Sea Level 0.0

YEAR - -	1860	1861	1862	1863	1864						MEANS.
January - -	3.45	.45	.76								
February - -	.95	3.98	.62								
March - - -	2.10		4.05								
April - - -	2.25	.75									
May - - -	3.16	6.77	2.70								
June - - -	3.72										
July - - -	2.69	1.15									
August - -	2.98										
September -	4.00		3.00								
October - -	2.90		6.55								
November -	2.05										
December -	2.70	1.60	3.50								
TOTALS -	33.45										

c & c



St. Leonards

Marine

J. L. Lavery Esq.

+ Ground 0.0

+ Sea Level 10 ft

YEAR - -	1860	1861	1862	1863	1864						MEANS.
January - -	3.45	.42	1.30								
February - -	1.03	.91	.61								
March - - -	1.83	2.52	3.89								
April - - -	2.25	.78	.97								
May - - - -	3.08	1.61	2.06								
June - - - -	3.60	6.12	1.18								
July - - - -	2.50	2.10	.86								
August - - -	2.67	1.18	1.50								
September -	3.96	4.06	1.89								
October - -	2.17	1.34	5.38								
November -	2.31	6.63	.82								
December -	1.92	1.62	2.50								
TOTALS -	30.77	29.29	22.96								



Hastings  
High St.

J A Langham

+ Ground 0.0

+ Sea Level 60 ft

YEAR - -	1860	1861	1862	1863	1864						MEANS.
January - -		<sup>#</sup> .39									
February - -		1.14									
March - - -		3.06									
April - - -		.91									
May - - - -		1.44									
June - - - -											
July - - - -											
August - - -											
September -											
October - -		1.55									
November -		6.32									
December -		1.76 <sup>#</sup>									
TOTALS -											

2



# RAINFALL AT *High Nickham*.....

*Hastings*

Observer *Edmund Field Esq.*

Rain { By..... *1.2 in 1862. 1.4 in 1865. 1.2 in 1866*  
 Gauge { Diameter..... *5*.....in. Height above Ground,.....ft.....in. *1863* Above Mean Sea Level.....ft. *212*.

YEAR.....	1860	1861	1862	1863	1864	1865	1866	1867	1868	1869	MEANS.
January.....	3.82	.43	1.46	2.94	.96	3.27	3.44	3.02	3.85	3.41	2.660
February .....	.97	.97	.65	.97	1.18	2.40	2.88	2.22	.87	2.25	1.536
March .....	1.61	2.23	3.19	.93	2.18	1.27	2.33	2.87	1.21	1.91	1.973
April.....	2.17	1.23	.82	.55	.72	.17	2.11	2.55	1.78	1.49	1.359 -
May .....	3.20	1.19	1.84	2.06	1.85	2.59	.93	3.13	.78	4.74	2.231
June.....	3.62	4.23	1.05	2.50	1.36	1.46	1.87	.80	.60	.74	1.823
July .....	2.39	2.14	1.50	.57	.36	1.57	1.81	3.69	3.54	.30	1.787
August.....	3.42	.91	1.63	2.28	1.58	2.29	2.54	1.45	4.49	1.82	2.241
September.....	4.29	3.26	2.20	3.56	2.37	.06	5.75	.81	1.13	3.78	2.721
October .....	2.00	1.28	5.44	2.49	1.58	9.35	1.07	2.68	2.82	1.39	3.010 +
November.....	2.79	5.45	.60	1.53	5.06	2.66	1.74	1.70	1.87	2.50	2.590
December.....	2.38	1.54	2.44	1.68	.86	1.56	2.18	1.35	6.94	3.49	2.442
TOTALS .....	32.66	24.86	22.82	22.06	20.06	28.65	28.65	26.27	29.88	27.82	26.373
	+ 0	0	0	0	- 0	0	0	0	0	0	0

1864 Max Nov. 24" = 1.60

1868 Nearly 3 in + average here, the chief characteristic of the year has been violent storms of wind & rain, the storm signal has been up 6 times in December and was always followed by storms some of which lasted three or four days, I have kept a register of 16 heavy gales during the year when the signal was up and only once was the signal up when no storm followed.



Hastings  
Bleak House  
John Banks Esq

8 in 1/3 after March 65  
4 ft + ground 80 ft + S.L.

YEAR - -	1860	1861	1862	1863	1864	1865	1866	1867	1868	1869	MEANS.
January - -	4.36	.61	1.21	1.16	1.23	3.44	5.00	3.68	3.44	2.42	2.655
February - -	.76	.88	1.02	.95	1.17	1.91	3.71	1.86	1.05	2.27	1.558
March - - -	2.23	2.34	3.94	(.26)	2.28	1.61	2.39	3.08	1.20	1.90	2.123
April - - -	1.95	.25	1.35	.50	.38	.24	2.20	2.51	1.72	1.30	1.240
May - - - -	3.46	1.36	1.55	2.48	2.00	3.10	1.04	3.14	.76	4.59	2.348
June - - - -	3.15	4.97	1.56	1.88	.90	1.61	1.78	.71	.51	1.69	1.776
July - - - -	2.72	2.23	1.37	.40	.18	1.46	1.86	3.77	2.54	.26	1.679
August - - -	3.49	.50	1.53	2.10	1.73	2.71	2.33	.96	4.15	1.70	2.120
September -	4.92	5.11	2.16	2.98	2.11	.00	6.20	.60	1.02	3.20	2.830
October - - -	2.73	2.35	7.75	2.13	1.81	10.88	1.47	2.74	2.80	1.79	3.645
November - -	2.68	5.77	.72	1.60	6.34	2.42	2.18	.85	1.67	2.17	2.640
December - -	1.80	1.30	(2.50) Damaged	2.39	.66	1.50	1.87	2.18	5.36	3.31	2.287
TOTALS -	34.25	27.67	(26.66)	18.83	20.79	30.88	32.03	26.08	26.22	25.60	26.901

L C C C L C C C C C  
1865 R & L 8 in f after March it and 8 in f again  
but sometimes the new one gets most



*Hastings*  
*Cemetery*  
*Mr. Edwin Field*

10      500-68  
5 in + ground 0.5 in + Sea Level 450 ft

YEAR - -	1860	1861	1862	1863	1864	1865	1866	1867	1868	1869	MEANS.
January - -		#	1.99	4.26	1.34	3.23	4.99	3.16	3.54	2.33	
February - -			.74	1.25	1.86	3.10	4.12	1.51	.77	1.91	
March - - -			4.16	1.00	2.70	1.55	1.80	3.27	1.30	1.29	
April - - -			1.21	.74	.94	.24	2.30	1.92	2.07	.99	
May - - - -			2.36	2.78	2.42	3.24	.85	2.93	1.11	4.62	
June - - - -			1.62	2.94	1.80	1.46	2.21	1.40	.18	.66	
July - - - -			1.85	.72	.66	2.09	1.76	3.39	3.23	.36	
August - - -			1.85	2.10	1.88	2.82	2.59	1.17	4.13	2.67	
September -			2.84	4.32	3.34	.12	6.26	1.19	.92	2.80	
October - -			7.49	3.61	2.25	10.15	2.05	3.98	2.17	1.02	
November -			1.00	1.81	6.31	3.44	2.33	.86	1.65	2.51	
December -			3.00	2.10	1.07	1.09	2.67	2.37	5.51	2.68	
TOTALS -			30.11	27.63	26.37	32.53	33.93	27.15	26.58	24.64	
			C	C	C	C	C	C	C	C	

*In open pasture*



## Twilight

Jas. Rock Jr.

May 1st Nov 98

6 6 2

50 or 62

Diam 8 in + Ground 9 in + Sea Level 490 ft

YEAR - -	1860	1861	1862	1863	1864	1865	1866	1867	1868	1869	MEANS.
January - -	3.07	.44	1.65	2.91	}						
February - -	.93	.93	.80	.93							
March - - -	1.68	2.42	3.45	.74							
April - - -	1.99	.81	.86	.62							
May - - - -	3.16	1.93	2.15	2.52							
June - - - -	3.49	4.85	1.60	2.60							
July - - - -	2.21	2.66	1.67	.58							
August - - -	2.28	1.25	1.82	2.31							
September -	4.25	3.74	2.18	3.28							
October - -	1.92	1.62	7.68	2.64							
November -	2.32	7.01	.75	1.50							
December -	2.24	1.49	2.57	1.46							
TOTALS -	29.54	29.15	27.18	22.09							

E E E E



RAINFALL AT Hollington

W. Hastings

Capt. Lewis

Rain { By.....  
Gauge { Diameter.....5.....in.

Height above Ground, 1... ft. 0... in. Above Mean Sea Level, 224... ft.

315 corrected 57

YEAR.....							1866	1867	1868	1869	MEANS.
January .....							<del>4</del> 4.41	4.30	3.89	3.17	
February .....							4.13	1.89	.94	1.87	
March .....							2.18	3.66	1.31	1.37	
April .....							2.03	2.33	1.95	1.38	
May .....							1.18	3.46	.92	4.53	
June.....							2.49	1.50	.60	.71	
July .....							2.49	3.81	2.28	.37	
August.....							2.68	1.63	4.09	2.22	
September ...							5.50	1.55	1.27	3.79	
October.....							2.13	3.45	2.83	1.83	
November.....							2.31	1.62	1.69	2.09	
December.....							2.41	1.80	6.42	3.89	
TOTALS .....							33.94	31.00	28.19	27.22	

c c c c



RAINFALL AT Oakhurst Or

J H Morgan

Hastings

Rain { By Cassella

Gauge { Diameter 5 in.

Height above Ground, 10 ft. 10 in.

Above Mean Sea Level, 354 ft.

YEAR.....								1867	1868	1869	MEANS.
January .....								# 3.72	4.13		
February .....								1.93	1.11		
March .....								3.36	1.44		
April .....								2.25	1.73		
May .....								3.02	1.16		
June.....								1.31	.65		
July .....								3.95	3.00		
August.....								1.57	4.32		
September ...								1.50	1.20		
October.....								3.43	3.46		
November.....								1.89	2.11		
December.....								1.72	6.72	#	
TOTALS .....								29.65	31.03		

C C



# RAINFALL AT Falmes

Observer.....R. R. Verrill.....

Rain { By.....  
 Gauge { Diameter.....in.      Height above Ground,.....ft.....in.      Above Mean Sea Level.....ft.

YEAR.....	1860	1861	1862	1863	1864	1865	1866	1867	1868	1869	MEANS.
January.....											
February .....											
March .....											
April.....											
May .....											
June.....											
July .....											
August.....											
September.....											
October .....											
November.....											
December.....											
TOTALS .....		33.37	39.71	35.49	24.55	40.49	35.44	28.46	35.26	33.31	



# RAINFALL AT *Lewes Glynde Place*

*Sussex*

Observer...*James M<sup>c</sup>Leod*.....

Rain { By.....

Gauge { Diameter.....*5*.....in.

Height above Ground, ..*3*.....ft.....*6*.....in.

Above Mean Sea Level...*45*.....ft.?

YEAR.....	1860	1861	1862	1863	1864	1865	1866	1867	1868	1869	MEANS.
January.....	5.08	.53	2.52	4.28	1.18	5.78	5.25	4.38	3.84	3.50	3.634
February.....	1.29	1.47	.61	1.01	1.88	2.86	5.17	2.27	1.26	3.16	2.098
March.....	2.08	3.14	4.31	1.11	3.72	1.76	2.17	2.95	1.60	2.25	2.509
April.....	1.98	.33	1.68	.44	.87	.28	1.52	3.01	2.65	1.41	1.417
May.....	3.65	1.93	3.53	2.39	1.91	3.29	.79	2.48	1.21	4.73	2.591
June.....	4.68	3.53	2.27	4.18	1.19	.92	2.54	1.66	.78	1.08	2.283
July.....	3.50	2.65	1.95	.60	.55	3.04	2.49	4.73	1.12	.35	2.098
August.....	5.31	1.15	1.99	2.73	2.39	3.20	3.19	2.27	4.12	1.40	2.775
September.....	4.53	5.03	2.46	5.05	3.57	.04	6.96	2.34	2.27	5.08	3.733
October.....	3.31	2.97	7.50	3.05	1.81	11.70	1.62	3.86	3.70	2.06	4.158
November.....	3.18	7.15	.78	1.87	5.93	3.34	2.72	1.73	1.19	2.97	3.086
December.....	2.44	1.80	3.08	3.20	.90	3.08	3.40	1.80	8.17	4.76	3.263
TOTALS.....	41.03	31.68	32.68	29.91	25.90	39.29	37.82	33.48	31.91	32.75	33.645

amounts taken by W<sup>r</sup> Symonds from observers daily  
 observation Book returns sent by W<sup>r</sup> M<sup>c</sup>Leod cast  
 wrong.

1864 Max 23<sup>rd</sup> Nov<sup>r</sup> 1.56

1868 Only twice during the last 12 years have we had  
 more than 7.00 in Nov<sup>r</sup> 1861 7.15 and Oct<sup>r</sup> 1862 7.50 but  
 this Dec<sup>r</sup> we have had 8.17 and 24 days on which it fell  
 18 days being the most of any of the previous years.



RAINFALL AT Lewes, Southmalling  
E. Sussex

Observer Miss M. H. Rickman

Rain { By.....  
Gauge { .....  
Diameter.....8...in. Height above Ground,.....ft.....5...in. Above Mean Sea Level...40...ft.  $\nearrow$

YEAR.....									1868	1869	MEANS.
January.....									<del>4</del> 4.52	2.97	
February.....									.83	3.26	
March .....									2.02	2.08	
April.....									2.90	1.48	
May .....									1.33	4.80	
June... ..									.66	1.03	
July .....									1.58	.37	
August.....									3.87	1.12	
September.....									1.64	3.99	
October .....									3.33	3.00	
November.....									1.12	2.83	
December.....									8.45	3.99	
TOTALS ....									32.25	30.92	







Battle

Super

J Webster

J Cruise Ap<sup>r</sup>

12 64

+ Ground <sup>14 in</sup> 1.3. 65 86

YEAR - -	1860	1861	1862	1863	1864	1865	1866	1867	1868	1869	MEANS.
January - -	<sup>\$</sup> .60	2.32	4.25	1.30	5.10	5.33	4.42	4.56	3.23		
February - -	1.80	.89	1.16	2.50	3.21	5.02	2.20	1.17	2.24		
March - - -	2.20	4.97	1.20	2.68	2.14	2.23	3.81	1.56	2.25		
April - - -	.80	1.30	.74	1.04	.26	2.21	2.35	2.14	1.49		
May - - - -	1.60	2.65	2.75	2.43	3.87	1.09	3.66	1.07	4.61		
June - - - -	1.80	1.91	3.73	1.48	1.44	1.77	1.55	.57	.79		
July - - - -	2.20	1.95	.78	.88	2.94	2.05	4.06	2.01	.31		
August - - -	1.34	2.14	2.30	2.24	3.33	3.25	1.75	3.83	2.03		
September -	4.89	2.56	4.16	4.00	.09	6.62	1.89	2.33	4.51		
October - -	1.67	8.14	3.52	2.15	11.88	1.72	3.56	3.61	2.07		
November -	7.50	.59	1.95	6.28	3.16	2.90	2.00	1.80	2.55		
December -	1.79	3.05	2.51	1.32	2.18	2.80	2.00	6.79	4.17		
TOTALS -	28.19	32.47	29.05	28.30	39.60	36.99	33.25	31.44	30.25		

1863 Wildest day in the year 20<sup>th</sup> Sept = 1.15



# RAINFALL AT *Battle Abbey Gardens*

Observer... *Thomas Jack* .....

Rain { By .....

Gauge { Diameter... *5* .....in.

Height above Ground, *1* .....ft.....in.

Above Mean Sea Level *215* .....ft.

YEAR.....										<i>1869</i>	MEANS.
January.....										<i>3.04</i>	
February .....										<i>1.53</i>	
March .....										<i>2.10</i>	
April .....										<i>1.26</i>	
May .....										<i>2.94</i>	
June.....										<i>.71</i>	
July .....										<i>.18</i>	
August.....										<i>1.34</i>	
September.....										<i>2.93</i>	
October .....										<i>1.23</i>	
November.....										<i>1.03</i>	
December.....										<i>2.59</i>	
TOTALS .....										<i>20.88</i>	

*Gauge here stands open to all weathers*



RAINFALL AT Walden Heather den House  
Sussex

Observer J. G. Boucher Esq

Rain { By.....  
Gauge { .....  
Diameter.....5.....in.

Height above Ground.....ft....2....in.

Above Mean Sea Level 4.00....ft.

YEAR.....									1868	1869	MEANS.
January.....									4.46	3.56	
February.....									1.16	2.88	
March.....									1.34	2.42	
April.....									1.96	1.81	
May.....									1.13	4.79	
June... ..									.76	1.34	
July.....									2.07	.40	
August.....									3.71	.99	
September.....									3.71	3.23	
October.....									2.99	1.96	
November.....									1.60	2.42	
December.....									6.86	4.13	
TOTALS ....									31.75	29.93	



Rainfall at Uckfield (Moleser Gore)

F. Brodie Esq

Ans return

g. in open field

Diameter of Gauge, ... 8 ... in.

Height above Ground, ..... ft. 6 ... in.

Above Mean Sea Level, ... 112 ... ft.

YEAR - -				1863	1864	1865	1866	1867	1868	1869	MEANS
January - -					.94	5.33	5.30	3.46	5.02		
February - -					x .96	1.73	4.67	1.79	1.13		
March - - -					3.40	1.66	1.66	2.98	1.57		
April - - -					1.11	.43	1.63	2.18	2.49		
May - - -					1.66	3.36	.77	1.99	1.07		
June - - -						1.17	1.21	2.94	1.79	.51	
July - - -				#.76	.53	4.32	2.77	5.20	2.69		
August - -				2.21	1.57	4.68	2.37	1.96	3.19		
September -				3.43	3.07	.03	5.82	2.26	3.11		
October - -				3.02	2.11	11.22	1.57	3.42	2.74		
November -				1.65	5.58	3.11	1.93	1.33	1.25		
December -				2.53	1.00	2.27	2.03	2.12	7.01		
TOTALS -					23.10	39.35	33.40	30.48	31.78		

x g. burst partly made up from Mr. Prince's return; his g. only 200 yds from me.



RAINFALL AT UckfieldObserver Col Price Esq

Rain { By .....

Gauge { Diameter 12 in.Height above Ground, 6 ft. 0 in.Above Mean Sea Level 149 ft.

YEAR.....	1860	1861	1862	1863	1864	1865	1866	1867	1868	1869	MEANS.
January.....	4.75	.23	2.27	3.67	.94	5.26	6.22	3.15	4.35	3.00	3.384
February .....	1.50	1.78	.80	.88	1.03	1.63	4.35	1.70	1.03	2.53	1.723
March.....	3.00	2.51	4.05	.91	3.64	1.82	1.95	3.02	1.52	2.28	2.470
April.....	2.53	.69	1.63	.46	1.04	.33	1.25	2.24	2.30	1.52	1.399
May .....	4.20	1.56	2.61	1.96	1.94	3.37	.70	2.07	1.03	3.98	2.342
June.....	4.80	2.88	2.03	3.81	1.01	1.35	2.77	1.87	.59	.96	2.207
July .....	3.00	2.85	1.43	.79	.46	4.86	2.83	5.25	2.98	.08	2.453
August.....	5.84	1.16	1.90	2.18	1.73	3.76	2.07	1.96	3.18	1.30	2.508
September.....	3.75	3.70	2.31	3.44	3.06	.02	6.12	2.33	3.01	4.33	3.207
October.....	2.97	1.85	7.00	3.23	2.09	11.23	1.61	3.41	2.64	1.06	3.789
November.....	2.95	7.50	.94	1.68	5.56	3.06	1.89	1.41	1.37	2.65	2.901
December.....	3.17	1.64	3.04	2.73	.98	2.28	2.03	2.07	6.51	4.08	2.853
TOTALS .....	42.46	28.35	30.01	25.74	23.48	38.97	33.79	30.48	30.51	28.57	31.266



## Bristol Park Super

C. L. Prince W. J. Huggell

Cool<sup>d</sup> Harcourt

7 65

11 in.

+ ground 6 ft.

+ S. I. <sup>104</sup> ~~200~~ ft.

YEAR - -	1860	1861	1862	1863	1864	1865	1866	1867	1868	1869	MEANS.
January - -	4.70	.61	2.04	4.22	1.13	5.14	6.80	3.85	5.39		
February - -	1.34	1.82	.67	.94	.98	2.07	5.91	1.93	1.32		
March - - -	3.35	3.09	4.25	.59	3.38	2.04	2.08	3.04	1.59		
April - - - -	3.07	.70	1.54	.77	.91	.38	1.39	2.07	2.86		
May - - - -	4.36	1.76	2.33	1.83	1.82	3.32	.91	1.72	1.24		
June - - - -	5.20	2.65	1.96	3.67	.98	1.39	2.95	1.89	.62		
July - - - -	3.10	3.63	1.47	.89	.55	4.06	3.06	5.36	3.24		
August - - -	5.53	1.06	2.14	1.92	1.76	4.20	2.88	2.18	3.52		
September -	4.76	4.76	2.33	3.64	3.02	.02	7.30	2.36	3.60		
October - -	3.31	2.28	6.94	3.15	2.02	11.98	1.74	3.35	3.54		
November -	3.68	8.40	1.02	2.17	5.74	3.95	2.98	1.30	1.83		
December -	3.15	1.81	3.15	2.90	1.00	2.74	2.97	2.38	8.62		
TOTALS -	45.55	32.57	29.84	26.69	23.29	41.29	41.05	31.43	37.46		

✓ C &amp; C C ✓ C C C C C

1860 - Agrees with Ans ret to C. L. Prince



RAINFALL AT Buxted Park

Observer...Wm. Huggitt.....

Rain { By.....  
Gauge { .....

Diameter.....in.      Height above Ground, 1 ft. 3 in.      Above Mean Sea Level.....ft.

YEAR.....									1868	1869	MEANS.
January.....									# 4.97		
February .....									1.28		
March .....									1.56		
April .....									2.57		
May .....									1.19		
June .....									.60		
July .....									3.43		
August .....									3.29		
September.....									3.36		
October .....									3.27		
November.....									1.71		
December .....									7.90		
TOTALS .....									34.73		

C



Rainfall at Ketches, Newrick

Miss Shiffner

5-68  
8-68  
4in 67

192 67

Diameter of Gauge, ...8... in.      Height above Ground, ..4... ft. 6... in.      Above Mean Sea Level, ...130... ft.

Glaisher

YEAR - -						1865	1866	1867	1868	1869	MEANS.
January - -						* 4.47	5.72	2.66	4.47	2.81	
February - -						2.02	4.20	1.75	.66	3.12	
March - - -						1.35	1.49	2.68	2.03	2.17	
April - - - -						.36	1.57	2.08	1.92	.95	
May - - - - -						3.23	.59	1.91	1.21	4.30	
June - - - - -						1.10	2.36	1.21	.45	1.04	
July - - - - -						3.98	2.55	4.60	1.58	.10	
August - - -						3.88	2.36	1.86	2.81	1.20	
September -						.07	4.79	2.14	1.89	3.08	
October - - -						10.70	1.73	3.03	3.03	2.70	
November - -						2.93	1.75	1.00	1.59	2.72	
December - -						1.54	1.70	2.51	6.72	3.47	
TOTALS - - -						35.71	30.81	27.43	28.36	27.71	

C C C C C



RAINFALL AT *Newrick*

*Beechlands*

*Blaauw*

Rain { By.....  
Gauge { Diameter.....in.      Height above Ground, ..... ft. .... in.      Above Mean Sea Level, ..... ft.

YEAR.....	1860	1861	1862	1863	1864	1865	1866	1867	1868	1869	MEANS.
January .....		.38	2.54	3.60	1.25	5.51					
February .....		1.76	.74	.97	1.27	1.92					
March .....		2.47	3.55	1.01	3.76	1.53					
April .....		.66	1.80	.54	1.02	.37					
May .....		1.69	2.75	2.11	1.99	3.24					
June.....		2.01	1.80	3.09	.90	1.18					
July .....		2.17	2.18	.74	.54	5.30					
August.....		1.03	1.84	2.61	1.74	3.84					
September ...		4.11	2.41	3.95	3.70	.22					
October.....		2.39	6.59	2.59	2.07	11.27					
November.....		7.19	1.07	1.83	6.04	3.62					
December.....		1.67	3.02	2.64	.91	3.04					
TOTALS .....		28.32	30.29	26.48	25.19	41.04					

*C C C C C*

*Observer could not do simple addition*



## Rectory Maresfield

Rev<sup>d</sup> Edward Innes - Primer

2 in 64

0 in

+ ground 1 foot 3-66

+ Sea Level <sup>182</sup>~~250~~ feet

YEAR - -	1860	1861	1862	1863	1864	1865	1866	1867	1868	1869	MEANS.
January - -	4.55	.47	2.44	3.66	1.28	5.43	5.92	3.42	4.54	3.15	3.486
February - -	1.28	2.01	.75	1.16	1.10	2.24	4.57	1.71	1.07	2.77	1.866
March - - -	2.38	2.60	4.26	1.02	3.70	1.91	1.94	2.83	1.62	2.14	2.440
April - - -	2.52	.61	1.67	.69	.98	3.6	1.06	1.96	2.56	1.54	1.395 -
May - - - -	3.41	1.87	2.36	1.99	1.84	3.32	.81	1.92	1.31	4.03	2.286
June - - - -	5.17	2.55	2.12	3.69	1.37	1.12	2.99	1.51	.57	1.04	2.213
July - - - -	2.61	3.09	1.68	.87	.59	4.54	2.44	5.43	3.51	.10	2.486
August - - -	5.56	1.05	1.92	2.16	1.83	4.63	2.90	2.17	3.25	1.29	2.676
September -	4.05	4.38	1.97	4.01	2.37	.02	5.82	2.16	3.25	4.34	3.237
October - -	2.70	1.96	6.87	3.14	2.08	12.32	1.62	3.45	2.78	2.19	3.911 +
November -	3.11	7.76	1.09	1.85	5.95	3.62	2.13	1.59	1.51	2.83	3.144
December -	3.36	1.90	3.46	2.50	1.31	2.70	2.14	2.08	6.76	4.38	3.059
TOTALS -	40.70	30.25	30.59	26.74	24.40	42.21	34.34	30.23	32.73	29.80	32.199

1860 Agrees with M<sup>s</sup> sent to G.L.P.3 Agrees with M<sup>s</sup> sent to G.L.P.



Forest Lodge  
Maresfield  
Capt<sup>n</sup> Noble F.R.S.

259.67  
301

0 in + ground 1 foot 2 in + Sea Level 300 feet

YEAR - -	1860	1861	1862	1863	1864	1865	1866	1867	1868	1869	MEANS.
January - -	4.16	.61	2.55	3.31	1.24	3.40	5.36	2.86	5.27	3.89	3.273
February - -	1.00	1.77	.72	1.06	.95	2.47	5.33	1.88	2.19	4.25	2.162
March - - -	2.15	2.39	3.93	.82	3.39	1.70	1.86	2.50	2.11	1.62	2.247
April - - -	2.57	.49	1.60	.59	.84	.43	1.34	2.15	2.57	1.41	1.393 -
May - - - -	3.45	1.27	2.72	1.43	1.48	3.14	.77	1.90	1.18	3.87	2.121
June - - - -	5.41	2.16	2.67	3.78	1.55	1.14	3.14	1.32	.60	1.33	2.310
July - - - -	2.55	3.03	1.57	.89	.60	4.32	2.61	5.26	2.49	.23	2.355
August - - -	5.84	.94	2.06	2.39	1.56	3.75	3.20	2.11	2.92	1.14	2.591
September -	4.04	4.26	2.09	3.69	3.93	.06	4.79	1.97	3.17	4.74	3.274
October - -	2.46	1.79	7.05	3.32	1.87	11.51	1.70	3.37	2.57	2.42	3.814 +
November -	2.57	6.72	1.15	2.10	5.03	3.43	2.03	1.41	1.69	2.84	2.891
December -	2.94	2.13	2.94	2.33	1.26	2.41	2.52	1.99	7.92	4.04	3.048
TOTALS -	39.02	27.56	31.05	25.71	23.70	37.84	34.73	28.72	34.68	31.78	31.479

By said to be under the lee side of Obs<sup>y</sup> 7 ft 2 in from NE corner  
1869 fell 1.32 - then Aug (13<sup>th</sup>) the latter half of June & the  
whole of July very dry, wells running short. Intense heat during  
the the drought of July and last half of Aug. ~~1869~~ .83 fell in  
little more than one hour during a E about 6 a.m. on 10<sup>th</sup> Sep.  
Heavy gales during the last four months during one tremendous  
gale on the 16<sup>th</sup> Dec. (from the W) the Bar: (reduced) marked  
28.779 the frost with which the year appeared about to  
conclude terminated on the 31<sup>st</sup> of Dec.

1860 Dec = 1.94647 = 38.02 in Mds return to Mr B.L.P.

1863 agrees with Mds. sent to Mr B.L.P.



Rainfall at Church House, SalehurstSam<sup>l</sup>. Boorman Jun<sup>r</sup>Diameter of Gauge, 4 in.Height above Ground, 4 ft. 2 in.Above Mean Sea Level, 75 ft.

YEAR - -	1860	1861	1862	1863	1864	1865	1866	1867	1868	1869	MEANS.
January - -				#	.82	5.28	5.76	3.85	4.57	3.20	
February - -					1.57	2.53	4.38	1.89	1.33	2.72	
March - - -					3.58	1.85	2.72	3.12	1.56	2.65	
April - - -					2.01	.29	1.75	1.92	2.05	1.50	
May - - - -					2.12	3.13	.97	2.74	1.02	3.40	
June - - - -					1.19	1.89	2.58	1.03	.58	.83	
July - - - -					.61	3.03	2.63	4.95	2.06	.69	
August - - -					1.78	2.93	3.63	1.84	3.01	1.02	
September -					3.26	.05	5.83	1.55	1.92	3.32	
October - -					2.01	8.80	2.24	2.76	3.36	2.40	
November -					6.85	6.95	1.84	1.69	1.82	1.95	
December -					1.25	1.66	2.46	1.65	8.03	3.25	
TOTALS -					27.05	38.39	36.79	28.99	31.31	26.93	

ly in open garden 400 yards from the Mother



RAINFALL AT *Naywards Heath*  
*Lunatic Asylum*

Observer.....*Rev J E Cralley*.....

Rain { By.....  
Gauge { Diameter.....*5*.....in.

Height above Ground,.....*1*.....ft.....in.

Above Mean Sea Level.....*250*.....ft.

YEAR.....										<i>1868</i>	<i>1869</i>	MEANS.
January.....										<i>3.91</i>	<i>3.95</i>	
February .....										<i>1.20</i>	<i>3.04</i>	
March .....										<i>1.58</i>	<i>1.93</i>	
April.....										<i>2.13</i>	<i>1.46</i>	
May .....										<i>1.25</i>	<i>4.32</i>	
June.....										<i>.49</i>	<i>1.37</i>	
July .....										<i>1.36</i>	<i>.33</i>	
August .....										<i>3.04</i>	<i>1.59</i>	
September.....										<i>2.67</i>	<i>4.29</i>	
October .....										<i>2.22</i>	<i>2.52</i>	
November.....										<i>1.32</i>	<i>2.76</i>	
December.....										<i>6.61</i>	<i>3.05</i>	
TOTALS .....										<i>27.78</i>	<i>30.61</i>	

*C C*



Balcombe Place  
w. Buckfield

J. A. Hunkley Esq.

W. Labor Garden 1/3 65 & 66 g

See <sup>n & z</sup> 8 + Ground 0 . + Sea Level 340

YEAR - -	1860	1861	1862	1863	1864	1865	1866	1867	1868	1869	MEANS.
January - -			# 3.45	4.08	1.66	3.71	5.94	4.09	5.09	3.94	
February - -			.63	1.34	1.36	2.98	6.32	2.12	1.39	3.80	
March - - -			5.48	.93	3.90	1.87	1.80	2.56	1.39	1.72	
April - - - -			1.97	.60	1.04	.43	1.75	2.42	2.39	1.71	
May - - - - -			3.36	1.96	1.59	3.21	1.02	1.83	1.08	3.56	
June - - - - -			2.72	3.68	1.37	1.07	3.26	2.23	.54	1.67	
July - - - - -			1.49	.94	.32	3.27	1.86	5.13	2.46	.36	
August - - -			1.62	2.48	1.14	4.04	2.64	2.08	2.78	1.38	
September -			2.22	4.08	3.44	.25	7.67	1.96	2.72	5.45	
October - -			6.78	3.30	2.07	9.42	1.45	3.37	2.74	2.98	
November -			1.45	2.67	4.98	3.81	2.30	1.69	1.50	2.85	
December -			2.95	2.34	1.29	1.75	2.73	1.66	8.38	4.46	
TOTALS -			34.12	28.40	24.16	35.81	38.74	31.14	32.46	33.88	

g e g c c c c c



RAINFALL AT *West Hothley Super*

*John Dudgeon*

*Pearcelands*

Rain { By .....  
Gauge { Diameter.....*5*.....in.

Height above Ground, *1* ft. .... in.

Above Mean Sea Level, *300*<sup>?</sup> ft.

YEAR .....							1866	1867	1868	1869	MEANS.
January .....							<sup>from 18<sup>th</sup></sup> # .86	3.37	4.91		
February .....							6.24	1.88	1.49		
March .....							1.94	2.47	1.87		
April .....							2.00	2.40	2.55		
May .....							1.26	1.72	.90		
June .....							3.20	2.14	.48		
July .....							2.44	5.23	3.61		
August .....							2.82	2.12	3.19		
September ...							7.72	1.97	2.42		
October .....							1.96	3.85	2.45		
November ...							2.49	.98	1.55		
December .....							2.82	2.20	7.82 <sup>#</sup>		
TOTALS .....							35.76	30.33	33.24		

*C C C*

*1868 July Tremendous Storm of which this seemed the centre on the night of the 11<sup>th</sup> & morning of 12<sup>th</sup> & evening of 12<sup>th</sup> until after midnight 3.43 in. of rain fell in 30 hours, marked on the morning of 12<sup>th</sup> 1.17*

*13    2.26  
-----  
3.43*

*ly open and exposed*



The Hyde, Crowley, Slougham Supes.

C. S. Biggs Esq.

5 63

in a walled garden

2 ft 6 2 4 5

400 6 2

Gauge 100 in area + ground 1 ft 6 in + Sea Level 300 ft

YEAR - -	1860	1861	1862	1863	1864	1865	1866	1867	1868	1869	MEANS.
January - -	5.08	.88	3.24	3.90	2.21	5.87					
February - -	1.48	2.70	.92	1.63	1.60	3.01					
March - - -	2.92	2.92	5.92	1.10	3.58	2.48					
April - - -	2.48	.83	2.63	1.03	1.15	.46					
May - - - -	3.49	2.33	4.19	2.41	1.75	3.91					
June - - - -	7.76	3.49	2.55	4.19	.52	1.05					
July - - - -	3.97	5.01	2.12	1.08	.28	2.75					
August - - -	5.89	.86	2.83	3.68	1.35	6.08					
September -	4.01	4.19	1.72	5.25	4.86	.41					
October - -	3.30	1.97	7.01	4.23	1.44	10.23					
November -	3.45	6.48	1.76	2.30	5.87	4.44					
December -	3.80	2.59	3.24	2.48	1.11	2.31	x				
TOTALS -	47.63	34.25	38.13	33.28	25.72	43.00					

C C C C C C

Gauge in front of an Orchard House which rather shelters it all else open







Frant

Super

R H Allnatt M.D.

+ ground 14' 2 in

+ Sea level 595

YEAR - -	1860	1861	1862	1863	1864	1865	1866	1867	1868	1869	MEANS.
January - -						4.55			4.01		
February - -						2.08			.91		
March - - -						1.91			2.55		
April - - - -						.35			2.69		
May - - - - -						4.50			1.09		
June - - - - -						1.57			.64		
July - - - - -						3.44			2.68		
August - - -						4.28			3.93		
September -						1.00			3.50		
October - - -						10.59			2.89		
November - -						4.34			1.89		
December - -						2.39			7.90		
TOTALS -						40.00			34.68		

C

C

On a lawn remote from any obstruction



# RAINFALL AT East Grinstead

60

WVK Stenning

Halsford

Rain { By.....  
Gauge { Diameter.....5.....in.

Height above Ground, ..1... ft. 3... in.

Above Mean Sea Level, ..400<sup>3</sup>... ft.

YEAR.....							1866	1867	1868	1869	MEANS.
January .....							5.82	4.04	4.55	3.78	
February .....							5.77	1.95	1.35	3.04	
March .....							2.11	3.25	1.72	2.28	
April .....							2.12	2.41	2.29	1.48	
May .....							1.42	1.67	.83	3.03	
June.....							3.50	1.98	.47	1.53	
July .....							3.09	4.93	1.82	.42	
August.....							2.24	1.85	3.01	1.05	
September ...							7.85	1.95	3.21	4.66	
October.....							1.71	3.67	2.70	2.52	
November.....							2.62	1.12	1.56	3.02	
December.....							1.95	2.03	7.30	4.70	
TOTALS .....							40.20	30.85	30.81	31.51	

C C C C